

Actuators

DC motor, brush-type

Quasi-absolute position detection, CANopen

MSQA 46 I36



MSQA 46 I36 connection axial

Features

- Actuator / CANopen
- Brush-type DC motor
- Quasi-absolute position detection
- Nominal power output 6 W
- 2 inputs programmable
- Fieldbus loops possible
- Separate communication and power supply

Technical data - electrical ratings

Voltage supply	24 VDC $\pm 10\%$
Current consumption	≤ 1.5 A
Nominal current	0.5 A
Starting current	Charging current capacitor 56 μ F
Operating current type	≤ 30 mA
Initializing time	≤ 1000 ms after power on
Positioning resolution motor	90 °
Positioning accuracy motor	± 45 °
Number of turns	1073 mio / 30 bit
Undervoltage interruption	≤ 18 V
Terminating resistor	Manually set by DIP switch
Loop controller	Integrated position and speed regulator (1Q)
Sensing method	Magnetic
Reverse polarity protection	Bus electronics
Excess temperature protection	110 °C (final power output circuit)
Interference immunity	DIN EN 61000-6-2
Emitted interference	DIN EN 61000-6-4

Technical data - mechanical design

Dimensions (flange)	$\varnothing 46$ mm
Shaft	$\varnothing 6$ mm
Nominal speed	280 rpm (i = 18) 64 rpm (i = 90)
Nominal power output	6 W
Nominal torque	0.2 Nm (i = 18) 0.4 Nm (i = 90)
Service life	300 h
Protection DIN EN 60529	IP 42
Ambient temperature	-15...+40 °C
Isolation class	F (+155 °C, DIN EN 60034-1)
Connection	Connector
Number of stages	3...4
Resistance	DIN EN 60068-2-6 Vibration DIN EN 60068-2-27 shock
Shaft surface	Bevel
Material	Housing: aluminium
S1 continuous operation	DIN EN 60034-1
Information	Service life at operating factor = 1.

Actuators

DC motor, brush-type

Quasi-absolute position detection, CANopen

MSQA 46 I36

Part number

MSQA 46C2P

92-I36BS3

Gear reducer

018 18 : 1

090 90 : 1

Connecting direction

A Axial

R Radial

Accessories

Connectors and cables

10123167	Female connector M9, 5-pin, straight, shielded, 5 m cable
10123171	Female connector M9, 5-pin, shielded, angled, 5 m cable, voltage supply and I/Os
10158249	Cable with male/female M12, 5-pin, angled, A-coded, 2 m
10156842	Cable with male/female M12, 5-pin, angled, A-coded, 5 m
10159388	Cable with male/female M12, 5-pin, shielded, straight, A-coded, 0.3 m (stub line)
10161398	Cable with male/female M12, 5-pin, shielded, straight, A-coded, 2 m
10161399	Cable with male/female M12, 5-pin, shielded, straight, A-coded, 5 m
10158246	Female connector M12, CAN, angled, A-coded, 2 m cable
10153968	Female connector M12, 5-pin, A-coded, straight
10145021	Female connector M12, 5-pin, CAN, angled
10153969	Cable connector M12, CAN, 5-pin, straight
10156584	Cable connector M12, 5-pin, CAN, angled
10153972	T-junction M12 CAN (1 male/2 female)
10153974	Terminating resistor CAN
10154968	Female connector D-SUB, 9-pin, CAN, angled, with terminating resistor

Programming accessories

10147362	CD-ROM with GSD-/EDS-/XML files and user manuals
10147798	USB-to-CAN adaptor

Motor-gearing-combination

Gear ratio	Torque nominal (Nm)		Rotational speed (rpm)		Admitted shaft load (N)		Weight (kg)	Length L (mm)		Positioning resolution (°)	Recordable revolutions	Gear efficiency approx.
	S1	S2*	S1	S2*	axial	radial		axial	radial			
18	0.2	0.45	280	213	15	30	0.5	105	121	2.5	59.6 Mio	0.73
90	0.4	0.9	64	58	20	45	0.5	107	123	0.5	11.9 Mio	0.66

* short time rating

Further motor - gear combinations upon request.

Actuators

DC motor, brush-type

Quasi-absolute position detection, CANopen

MSQA 46 I36

Terminal assignment

Connector – M9, 5-pin

Connector	Signal	Description
Pin 1	0 VME	0 VDC voltage s. motor / electronic
Pin 2	+VsM	+24 VDC voltage supply motor
Pin 3	Input 2	Input programmable
Pin 4	+VsE	+24 VDC voltage supply electronic
Pin 5	Input 1	Input programmable
	Shield	Housing

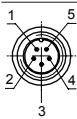

Connector male / female – M12, 5-pin, A-coded

Connector	Signal	Description
Pin 1	n.c.	–
Pin 2	+VsE	+24 VDC voltage supply electronic
Pin 3	CAN_GND / CAN Ground / 0 VE	0 VDC voltage supply electronic
Pin 4	CAN_H	Bus (dominant HIGH)
Pin 5	CAN_L	Bus (dominant LOW)
	Shield	Housing

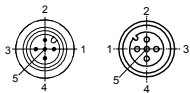

Technical data - communication

Interface	CANopen
Output circuit	CAN bus standard ISO / DIS 11898
Profile conformity	CANopen CiA DS 301 V4.02, DSP 305 V1.0, DSP 402 V2.0
Cyclic data transfer	PDO
Node Guarding	Node Guarding, Life Guarding, Heartbeat
Transmission rate	10...1000 kbit/s
Galvanic insulation bus	No
Inputs	2 digitally programmable
Switching frequency Inputs	<500 Hz
Setting switch	Manual setting of bus address, baud rate and terminating resistor
Operating modes	Position-controlled operation, Referencing
Diagnostic functions	Temperature control Self-diagnosis Position error
Programming software	Yes
Default settings	50 kbit/s, Node ID 1, terminating resistor OFF

Actuators

DC motor, brush-type

Quasi-absolute position detection, CANopen

MSQA 46 I36

Dimensions

MSQA 46 I36 connection axial

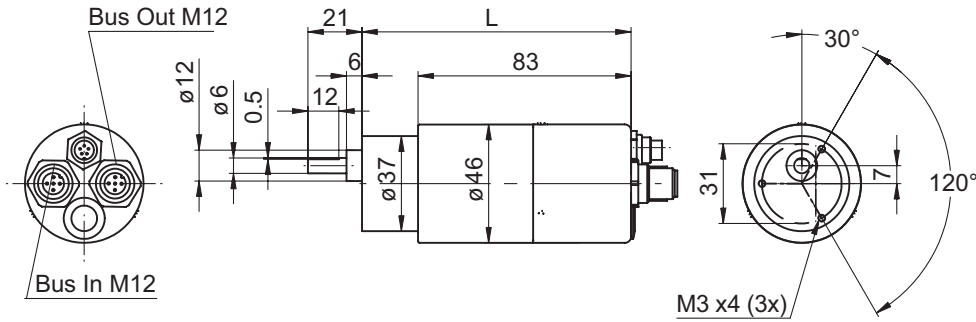

MSQA 46 I36 connection radial

