

Accessories

Mounting accessories

Z 119.053



Features

- Quick, secure and easy mounting
- To be mounted on the motor's fan guard

Description

Fix spring coupling onto flange by help of the attached screws. Push encoder onto the drive shaft and mount Spring coupling onto the contact surface.

Part number

Z 119.053 Spring coupling height 19.1 mm

Scope of delivery

Included: spring coupling, two screws M3 x 6

Suitable for

G0A2H, G0AMH, G0L2H, G0LMH, G0M2H, G0MMH,
G0P5H, GBA2H, GBA2S, GBAMH, GBAMS, GBMMH,
GBMMS, GBP5H, GEMMH, GXA2S, GXAMS, GXL2S,
GXLMS, GXM2S, GXM7S, GXMMS, GXP5S

Dimensions

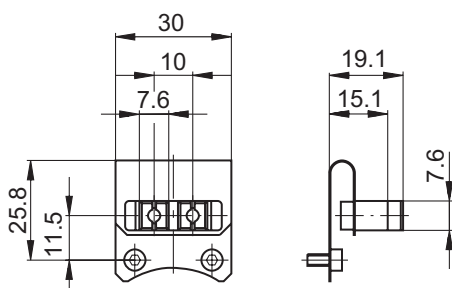

Dimension

