

## Through beam sensors

## OSDK 10D9005/S35A

## dimension drawing

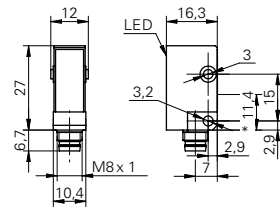

\* emitter axis

## general data

type	through beam laser sensor
emitter / receiver	emitter
light source	pulsed red laser diode
actual range $S_b$	8 m
nominal range $S_n$	10 m
laser class	1
distance to focus	parallel beam
wave length	650 nm

## electrical data

voltage supply range +Vs	11 ... 30 VDC
current consumption max. (no load)	30 mA
current consumption typ.	25 mA
reverse polarity protection	yes

## mechanical data

width / diameter	10,4 mm
height / length	27 mm
depth	16,3 mm
type	rectangular
housing material	plastic (ASA)
front (optics)	PMMA
connection types	connector M8 4 pin

## ambient conditions

operating temperature	-10 ... +50 °C
protection class	IP 67

## photo



## connection diagram

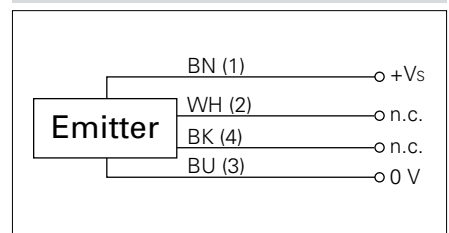

## laser warning

**CLASS 1 LASER  
PRODUCT**

Complies with 21 CFR 1040.10 and 1040.11  
except for deviations pursuant to laser  
notice No. 50, dated June 24, 2007