

## Inductive proximity switch

## IFRM 30P3501/S14L

## dimension drawing

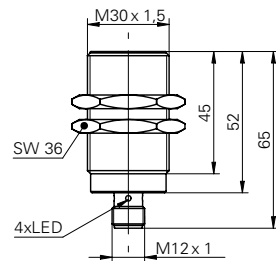

## general data

|                                |                     |
|--------------------------------|---------------------|
| mounting type                  | shielded            |
| nominal sensing distance $S_n$ | 10 mm               |
| hysteresis                     | 3 ... 20 % of $S_r$ |
| output indicator               | 4 port LED red      |

## electrical data

|                                    |                         |
|------------------------------------|-------------------------|
| switching frequency                | < 500 Hz                |
| voltage supply range +Vs           | 10 ... 50 VDC           |
| current consumption max. (no load) | 10 mA                   |
| output circuit                     | PNP break function (NC) |
| voltage drop $V_d$                 | < 3 VDC                 |
| output current                     | < 200 mA                |
| short circuit protection           | yes                     |
| reverse polarity protection        | yes                     |

## mechanical data

|                         |                      |
|-------------------------|----------------------|
| type                    | cylindrical threaded |
| material (sensing face) | PBT                  |
| housing material        | brass nickel plated  |
| dimension               | 30 mm                |
| housing length          | 65 mm                |
| connection types        | connector M12        |

## ambient conditions

|                       |                |
|-----------------------|----------------|
| operating temperature | -25 ... +75 °C |
| protection class      | IP 67          |

## photo



## connection diagram

