

## Inductive proximity switch

## IFRM 08P17G1/L

## dimension drawing

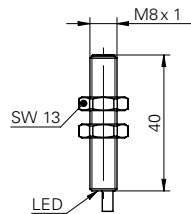

## general data

mounting type	quasi shielded
special type	enhanced distance (GammaProx)
nominal sensing distance $S_n$	3 mm
hysteresis	2 ... 25 % of $S_r$
output indicator	LED red

## electrical data

switching frequency	< 1 kHz
voltage supply range +Vs	12 ... 30 VDC
current consumption max. (no load)	18 mA
output circuit	PNP make function (NO)
voltage drop $V_d$	< 2 VDC
output current	< 200 mA
short circuit protection	yes
reverse polarity protection	yes

## mechanical data

type	cylindrical threaded
material (sensing face)	PBT
housing material	stainless steel
dimension	8 mm
housing length	40 mm
connection types	cable, 2 m

## ambient conditions

operating temperature	-25 ... +75 °C
protection class	IP 67

## photo



## connection diagram

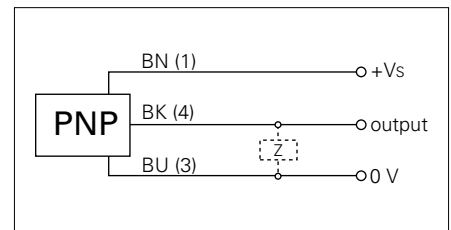

- Not for flush mounting in mild steel
- triple sensing distance