

ON/OFF
POWER SWITCH

449.58 mm
[17.700 in]

41.05 mm
[1.616 in]

205.30 mm
[8.083 in]

41.28 mm TYP
[1.625 in]

27.05 mm TYP
[1.065 in]

SECTION A-A
(VIEW FROM FRONT)

RESETABLE CIRCUIT
BREAKER

6' FOOT
POWER CORD
(NEMA 5-15P)

29.18 mm
[1.149 in]

5.08 mm
[0.200 in]

ASSEMBLY - VIEW FROM END

456.49 mm
[17.972 in]

ASSEMBLY - VIEW FROM SIDE

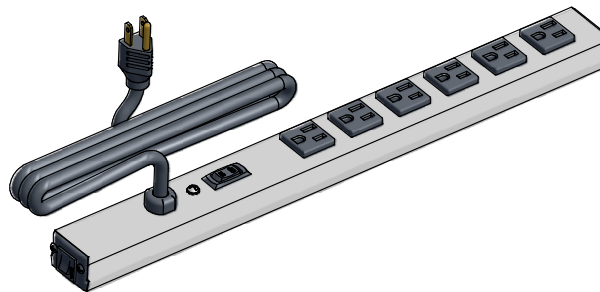

ISOMETRIC VIEW

15851H6A1

Finish - Case - Anodized Aluminum Extrusion

Ends - ABS Plastic

Rated - 125 VAC, 60 Hz, 15 Amps

Approvals - CSA Certified Standards C22.2 (No. 21-95, 42-99)
- UL Listed Standard UL1363

Cord Length

15851H6A1 - 6' Foot Power Cord (NEMA 5-15P)

15851H6B1 - 15' Foot Power Cord (NEMA 5-15P)

Accessories Included

Mounting Bracket Kit with Hardware



HAMMOND
MANUFACTURING™

15851H6A1

www.hammondmfg.com