

MCD Capsule differential pressure gauges

Ø 150 mm

Maximum static pressure 250 mbar (4 psi)

Δ P from : 0 ... 10 mbar to 0 ... 250 mbar (4 psi)

For non corrosive gases and aggressive environment

Safety valve on high pressure side

Accuracy 2 %



High pressure
connection HP

Low pressure
connection LP

MCD stainless steel capsule pressure gauges are designed for measuring small differential pressures on clean and dry air or gas systems. They are particularly appropriate for air conditioning and ventilation installations.

Specifications (20°C)

Operating principle	The capsule receives the high pressure and the case the low pressure (filtered gas). The differential pressure is obtained by the deformation of the diaphragm resulting from the inside pressure (HP) reduced by the outside pressure (LP).	Acceptable overpressures	A safety valve protects the capsule in case of sudden overpressure on the high pressure side (up to 250 mbar). There is no safety valve on the low pressure connection. Maximum differential overpressure is limited to 130 % of the full scale range.
Ranges	For maximum static pressure : 250 mbar (4 psi). Differential pressure: 0 ... 10 mbar to 0 ... 250 mbar (see table overleaf).	Recommendations	Pressure should be allowed on both sides simultaneously. The use of two taps and one by-pass is recommended. The volume of the medium to be measured should be greater than 4 dm ³ at each pressure connection (in order to minimize the possible variation of static pressure).
Accuracy	± 2 % of full scale.	Options	
Standard degree of protection	IP 66 according to EN 60529.		
Sensing element	1.4404 (AISI 316 L) stainless steel capsule.		
Threading	G 1/2 or 1/2 NPT.		
Gauge working Temperature	-20° ... 70°C		
Case and bezelring	1.4301 (AISI 304) stainless steel. Bayonet lock type.		
Window	Glass, 3 mm thick.		
Window gasket	Elastomer. Provides seal between window and case.		
Movement	Brass.		
Dial	Aluminium alloy. Black graduations and figures on white background.		
Pointer	Aluminium alloy, balanced, black painted.	Other units than mbar and kPa	
		Other threads smaller than or equal to G 1/2	
		1.4404 (AISI 316 L) stainless steel case and bezelring	
		Safety laminated glass (Triplex) window Code 0751 or Polymethacrylate (Plexi-glass) Code 0752	
		Stainless steel movement Code 0651	
		Oxygen application Code 0765	

Dimensions (mm) - Type of mounting

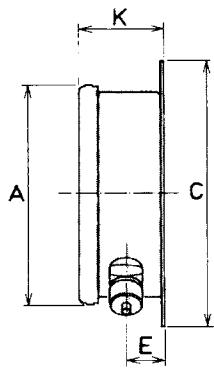

Type A

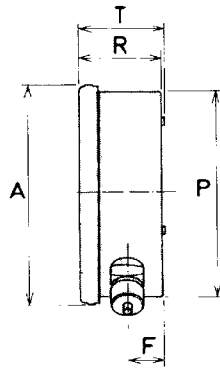

Type D

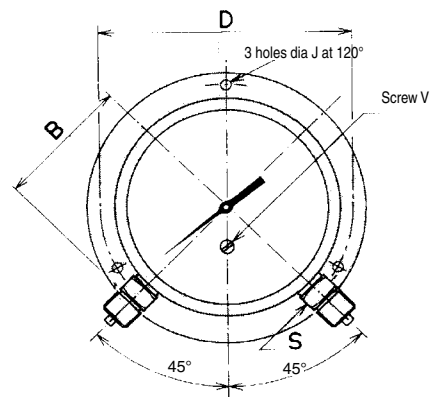

∅	A	B	C	D	E	F	J	K	P	R	S	T	Weight (kg)
150	150.2	90	180	168	25.4	23	5.5	56.4	142	54.5	22	56.1	0.9

Ordering details - MCD

		MCD7xx0xxx
Family	1' digit	
Pressure gauges		M
Type	2'...3' digit	
MCD		CD
Dial diameter	4' digit	
∅ 150 mm		7
Type of mounting* and connection position	5' digit	
bottom connection, back flange		A
bottom connection		D
* Option 1.4404 (316L) stainless steel change A with 1 and D with 4		
Hydraulic connection	6' digit	
G 1/2		3
1/2 NPT		6
Type of liquid filling	7' digit	
without filling		0
Measurement unit	8' digit	
mbar		N
kPa		D
Pressure range	9'...10' digit	
See codes in table		xx

code	Range for static pressure maximum 250 mbar or 25 kPa	
	ΔP graduation	
	mbar	kPa
03	0 + 10	0 + 1
04	0 + 16	0 + 1.6
05	0 + 25	0 + 2.5
06	0 + 40	0 + 4
07	0 + 60	0 + 6
08	0 + 100	0 + 10
09	0 + 160	0 + 16
10	0 + 250	0 + 25

UK/04-2007 This data sheet may only be reproduced in full