

Encoders without bearing

Hollow shaft $\varnothing 10$ to $\varnothing 45$ mm

Resolution 20, 50 pulses

ITD 67 A 4 Y 9



ITD 67 A 4 Y 9 with hollow shaft

Features

- Magnetic sensor with rotor
- Magnetic sensing
- Resolution 20 and 50 pulses
- Output circuits: HTL
- Without own bearings
- Rotor mounting by 2 set screws
- Cable output radial

Technical data - electrical ratings

Voltage supply	8...26 VDC
Reverse polarity protection	Yes
Consumption w/o load	≤ 20 mA
Resolution (steps/turn)	20...50
Output signals	A, B
Output circuit	Push-pull
Output current	≤ 20 mA

Technical data - mechanical design

Shaft	$\varnothing 10$...45 mm hollow shaft
Motor shaft tolerance	0.2 mm axial 0.05 mm radial
Protection DIN EN 60529	IP 67 (relating to sealed electronics)
Operating speed	≤ 10000 rpm
Materials	Housing: plastic Shaft: aluminium
Operating temperature	-20...+85 °C
Resistance	DIN EN 60068-2-6 Vibration 10 g, 55-2000 Hz DIN EN 60068-2-27 Shock 100 g, 11 ms
Weight approx.	230 g
Admitted cable length	15 m
Connection	Cable 1 m

Encoders without bearing

Hollow shaft $\varnothing 10$ to $\varnothing 45$ mm

Resolution 20, 50 pulses

ITD 67 A 4 Y 9

Part number

ITD 67 A 4 Y 9

	H		KR1	S		IP67
--	---	--	-----	---	--	------

Protection
IP67 IP 67

Hollow shaft
10 Hollow shaft $\varnothing 10$ mm
14 Hollow shaft $\varnothing 14$ mm
15 Hollow shaft $\varnothing 15$ mm
16 Hollow shaft $\varnothing 16$ mm
20 Hollow shaft $\varnothing 20$ mm
22 Hollow shaft $\varnothing 22$ mm
25 Hollow shaft $\varnothing 25$ mm
27 Hollow shaft $\varnothing 27$ mm
30 Hollow shaft $\varnothing 30$ mm
35 Hollow shaft $\varnothing 35$ mm
40 Hollow shaft $\varnothing 40$ mm
45 Hollow shaft $\varnothing 45$ mm

Operating temperature
S -20...+85 °C

Connection
KR1 Cable 1 m, radial

Output signals

AX A
BX A, B

Voltage supply / signals
H 8...26 VDC / HTL level, push pull

See part number (pulses)

Part number (pulses)

20 | 50

Encoders without bearing

Hollow shaft $\varnothing 10$ to $\varnothing 45$ mm

Resolution 20, 50 pulses

ITD 67 A 4 Y 9

Output signals

Clockwise rotation when looking at the mounting side.

AX-Output signals

Track A

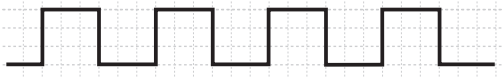

BX-Output signals

Track A

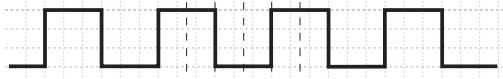

Track B



90°

Terminal assignment

Core colour	Assignment
green	Track A
grey	Track B
brown	UB
white	GND
transparent	Shield/Housing

Trigger level

Outputs	Push-pull short-circuit proof
Output level High	$\geq \text{UB} - 3 \text{ V}$
Output level Low	$\leq 1.5 \text{ V}$
Load	$\leq 20 \text{ mA}$

Dimensions

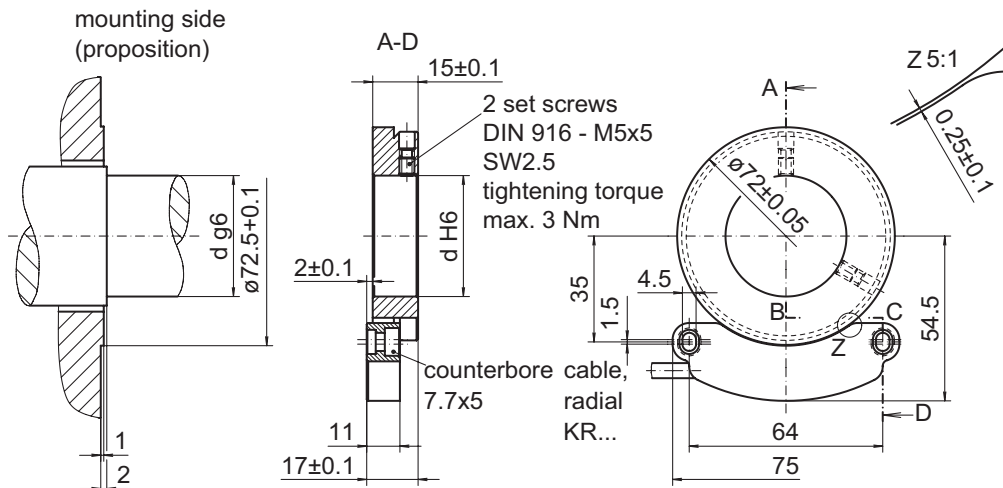

031- 5 Y 9

Encoders without bearing

Hollow shaft $\varnothing 10$ to $\varnothing 45$ mm

Resolution 20, 50 pulses

ITD 67 A 4 Y 9