

Incremental encoders

Hollow shaft $\varnothing 10-16$ mm

Resolution 1...2500 pulses

HOG 8



HOG 8

Technical data - electrical ratings

Voltage supply	5 VDC ± 5 % 9...26 VDC
Consumption w/o load	≤ 100 mA
Resolution (steps/turn)	1...2500
Phase shift	$90^\circ \pm 20^\circ$
Scan ratio	40...60 %
Reference signal	Zero pulse, width 90°
Sensing method	Optical
Output frequency	≤ 120 kHz
Output signals	K1, K2, K0 + inverted
Output circuit	TTL (RS422) HTL (power linedriver)
Interference immunity	DIN EN 61000-6-2
Emitted interference	DIN EN 61000-6-4
Approval	UL approval / E256710

Features

- Encoder with hollow shaft $\varnothing 10-16$ mm
- Optical sensing
- Compact, robust die-cast housing
- Logic level TTL with regulator UB 5 VDC / 9...26 VDC
- Logic level HTL with power linedriver

Optional

- Cone shaft $\varnothing 17$ mm (1:10)
- Option 1: Torque sheet
- Option 2: Support plate for torque arm

Technical data - mechanical design

Dimensions (flange)	$\varnothing 86.5$ mm
Shaft	$\varnothing 10...16$ mm hollow shaft
Shaft loading	≤ 100 N axial ≤ 200 N radial
Protection DIN EN 60529	IP 54
Operating speed	≤ 12000 rpm (mechanical)
Operating torque typ.	1 Ncm
Rotor moment of inertia	18 gcm ²
Materials	Housing: aluminium die-cast Shaft: stainless steel
Operating temperature	$-30...+85$ °C
Resistance	IEC 60068-2-6 Vibration 10 g, 20-2000 Hz IEC 60068-2-27 Shock 100 g, 6 ms
Connection	Connecting terminal
Weight approx.	550 g

Incremental encoders

Hollow shaft $\varnothing 10-16$ mm

Resolution 1...2500 pulses

HOG 8

Part number

HOG 8

Voltage supply / signals
C 9...26 VDC / output circuit
HTL (C) (for output signals D)
CI 9...26 VDC / output circuit
HTL (C) with inverted signals
(for output signals DN)
TTL 5 VDC / output circuit TTL
with inverted signals
R 9...26 VDC / output circuit
TTL with inverted signals (for
output signals DN)

See part number (pulses)

Output signals

D K1, K2

DN K1, K2, K0

Accessories

Connectors and cables

HEK 8 Sensor cable for encoders

Mounting accessories

DMS 6 Torque arm size M6

Diagnostic accessories

HENQ 1100 Analyzer for encoders

Part number (pulses)

1	12	62	300	1024
2	15	64	360	1042
3	20	100	400	1200
4	25	120	500	1250
5	30	176	512	2048
6	36	180	600	2500
8	40	192	720	
10	50	200	900	
11	60	250	1000	

Other pulse numbers upon request.

Incremental encoders

Hollow shaft $\varnothing 10-16$ mm

Resolution 1...2500 pulses

HOG 8

Output signals

at positive rotating direction

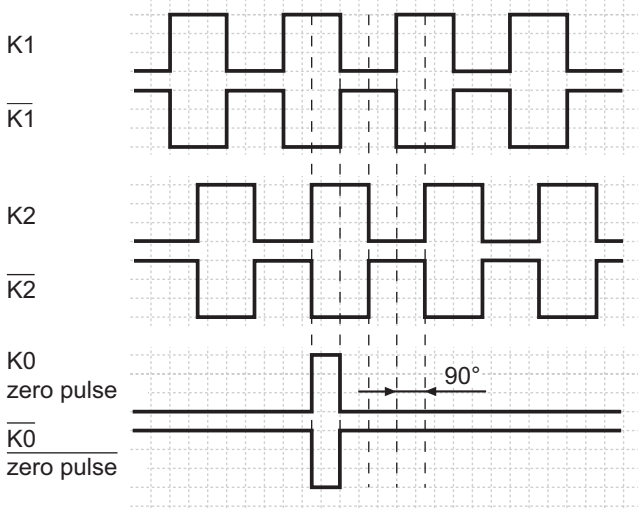

Terminal assignment

View A - Connecting terminal

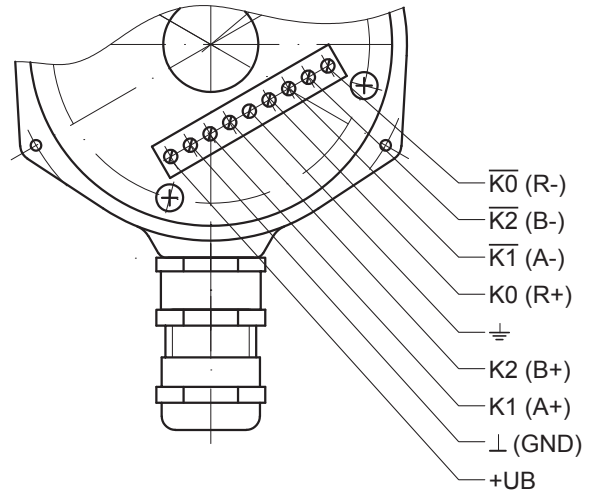

Dimensions

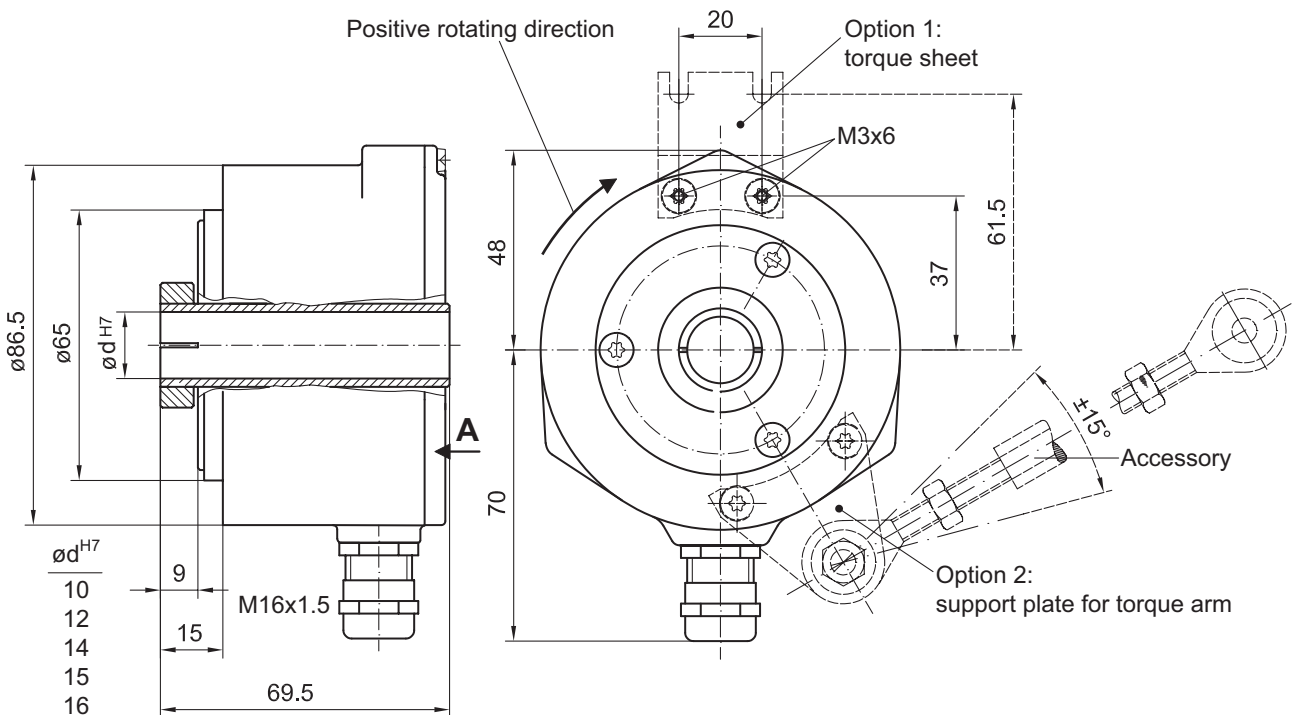

Incremental encoders

Hollow shaft \varnothing 10-16 mm

Resolution 1...2500 pulses

HOG 8