

# MEC5 Stainless steel gauges with electrical contacts DN 100

Ø 100

All stainless steel pressure gauge with electrical contacts

For corrosive fluids and atmospheres

Resistant to transient overpressure (CESA)

Sealed case, not fillable

Mechanical part conforms to Pressure Directive PED 97/23/CE

Electrical part conforms to Low Voltage Directive 73/23/CE

Based upon the MEX5, they are fitted with electrical contact blocks mini-maxi.

Stainless steel



## Specifications (20°C)

<b>Measurement range</b>	stainless steel sensing element 0...4 to 0...600 bar
<b>Mini measurement ranges</b>	2 contacts with magnet : 0...4 bar
<b>Gauge Working temperature</b>	-20...70°C The gauge may be used on fluid temperatures up to 200°C providing that the gauge temperature does not exceed 70°C.
<b>Thermal drift</b>	±0.4% for a variation of ±10°C in relation to the reference temperature (20°C).
<b>Accuracy class</b>	class 2.5 full scale (in the working zones)
<b>Degree of protection</b>	IP 65 (EN 60529)
<b>Sensing element and connection</b>	

<b>CONNECTION MATERIAL</b>	1.4404 stainless steel (AISI 316L)
<b>CONNECTION SHAPE</b>	22 mm square
<b>THREAD</b>	G 1/2 or 1/2 NPT
<b>SENSING ELEMENT MATERIAL</b>	1.4571 (316 Ti) - seamless drawn tube
<b>TUBE SHAPE</b>	In C P < 60 bar Helicoil P ≥ 60 bar

<b>Case and bezel ring</b>	1.4301 (AISI 304) stainless steel. Bayonet locking. With a safety blow out disc at the top of the gauge.
<b>Window</b>	Convex transparent polycarbonate cover with watertight index adjustment knob.
<b>Movement</b>	Stainless steel with zero and overrange stops
<b>Window gasket</b>	Elastomer

<b>Dial</b>	Aluminium alloy Black figures and lines on a white background
<b>Pointer</b>	Aluminium alloy, balanced and black painted
<b>Electrical connection</b>	Front plug Solder terminal lug Cable gland PG7

Block diagram showing the contact block control functions

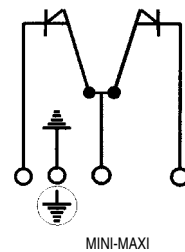

Characteristics of electrical contacts and relays: see data sheet A21.33

### Options

1.4404 (AISI 316L) stainless steel sensing element with seamless drawn tube (for 4 bar < P < 600 bar).	<b>Code 0816</b>
Oxygen application.	<b>Code 0765</b>
Special threads: smaller than or equal to G 1/2 or 1/2NPT	
Restrictor screw.	<b>Code 0771</b>



**Baumer**

## Dimensions (mm)

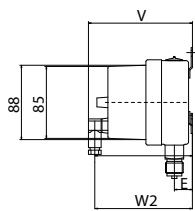

Type A

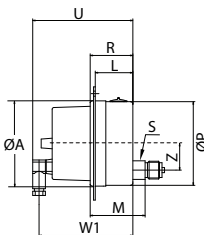
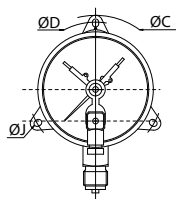

Type B

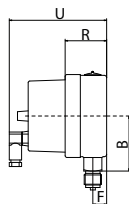
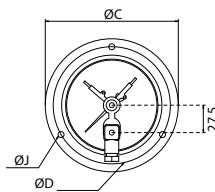

Type D

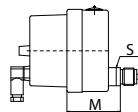

Type F

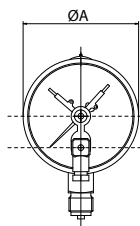

Dimensions mm	A	B	C	D	E	F	J	L	M	P	R	S	U	V	W1	W2	Z
	101	67	134	118	21.5	17	5.5	44.5	64	99	50.5	22	118.5	122.5	111	115	31.5

## Ordering details - MEC5

		MEC5xxxxxx	
<b>Family</b>	1' digit		
Pressure gauges		M	
<b>Type</b>	2'...3' digits		
MEC (inox)		EC	
<b>Case diameter</b>	4' digit		
Ø 100 mm		5	
<b>Type of contacts</b>	5' digit		
Mini-Maxi		4	
<b>Type of mounting and connection position*</b>	6' digit		
bottom connection, 3 mounting lugs at back		A	
back connection, front flange		B	
bottom connection		D	
back connection, 3 mounting lugs at back		E	
back connection		F	
* Option Stainless steel case and bezel ring inox 1.4404 (316L) change A with 1, B with 2, D with 4, E with 5 and F with 6			
<b>Hydraulic connection</b>	7' digit		
G1/2		3	
1/2 NPT		6	
<b>Type of liquid filling</b>	8' digit		
Without filling		0	
<b>Unit of measurement</b>	9' digit		
bar		B	
kPa		D	
psi		H	
<b>Pressure range</b>	10'...11' digits		
See table		xx	

code	bar	kPa	code	Psi
19	0 + 4	0 + 400	19	0 + 60
20	0 + 6	0 + 600	21	0 + 100
22	0 + 10	0 + 1000	22	0 + 160
24	0 + 16	0 + 1600	23	0 + 200
26	0 + 25	0 + 2500	25	0 + 300
27	0 + 40	0 + 4000	26	0 + 400
29	0 + 60	0 + 6000	27	0 + 600
31	0 + 100	0 + 10000	30	0 + 1000
33	0 + 160	0 + 16000	31	0 + 1500
35	0 + 250	0 + 25000	34	0 + 3000
38	0 + 400	0 + 40000	38	0 + 6000
39	0 + 600	0 + 60000		

UK/02-2008 This data sheet may only be reproduced in full