



REED SWITCH DEVELOPMENTS CORP.

2524 Norwood Court
Racine, WI 53403
Ph: (262)883-9060

sales@reedswitchdevelopments.com

SPECIFICATION SHEET

Assembly Part Number:
2020-1710-100

Reed Specifications

Physical		Operating		Electrical	
Configuration*	SPDT	Pull in (+/- 2AT)*	50 - 65	AC Contact Rating	N/A VA
Form*	C	Drop out*	N/A	DC Switching Voltage	120 VDC
Contact Position	OFFSET	Operate Time (Including Bounce)	4.00	AC Switching Voltage	85 VAC
Glass L	32.89 mm	Bounce Time	N/A	DC Switching Current	3.00 A
Glass D	5.33 mm	Release Time	3.90	AC Switching Current	3.00 A
Total L*	85.98 mm	Resonant Frequency	N/A	DC Max Carry Current	3.60 A
Wire D	1.02 mm	Max Operating Frequency	N/A	AC Max Carry Current	3.60 A
Gap Location	N/A	Operating Temperature Range	-40 - 105 °C	Min Breakdown Voltage	150 VDC
Mount Spec*	THRU	Storage Temperature	N/A °C	Max Initial Contact Resistance	500 mOhm
Contact Material	TUNGSTEN	DC Contact Rating	100 W	Typical Initial Contact Resistance	N/A mOhm
Max Vibration Resistance	N/A G	AC Contact Rating	N/A VA	Max Contact Capacitance	1.60 pF
Max Shock Resistance	N/A G	DC Switching Voltage	120 VDC	Min Insulation Resistance	10^10 Ohm
Lead Tensile Strength	N/A KG	AC Switching Voltage	85 VAC		

* Pre-processed, bare reed element

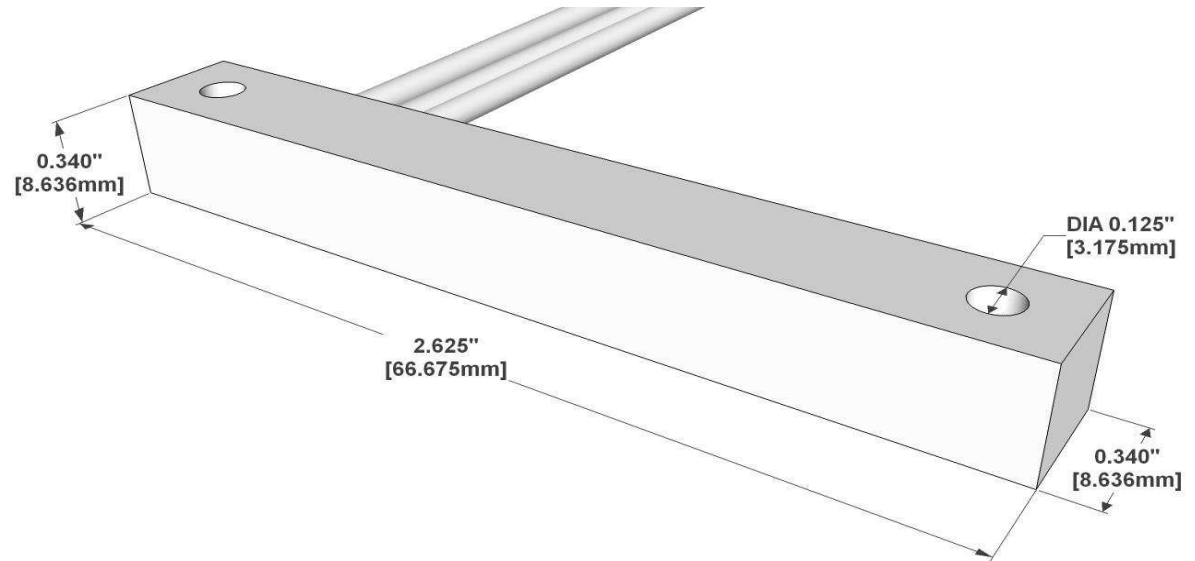

Assembly Characteristics

Housing	2020
Housing Material	CELANEX 3316
Reed	1710
Configuration	SPDT
Form	C

Wire/Cable Characteristics

Type	WIRE
Length	6.0/152.4 in/mm
Conductor Count	3
Colors	RED, BLK, WHT
Insulation Material & Description	PVC
Gauge	22 AWG
Stranded Copper	7 STR
Maximum temperature	105 °C

Standard Actuator/Minimum Make Distance

2020-4100-000 - Alnico 5 - Cylinder	.69/17.53	in/mm
-------------------------------------	-----------	-------

Assembly Certifications

UL RECOGNIZED (File #: E102207)	Y	
RoHS	Y	

For More Information Visit:
www.reedswitchdevelopments.com

Or Call Us At:
262-883-9060

IT SHALL BE THE RESPONSIBILITY OF THE BUYER TO ENSURE THAT THE GOODS ARE SUFFICIENT AND SUITABLE FOR THE PURPOSE OR PURPOSES INTENDED (WHETHER BY THE BUYER OR BY ANY THIRD PARTY) AND THAT THEIR CAPACITY AND PERFORMANCE IS NOT ADVERSELY AFFECTED BY ANY ITEMS USED IN THEIR INSTALLATION (WHERE RELEVANT) AND/OR IN CONNECTION WITH THEM.