

POSITION OF COLOUR STRIPE (see note 3)

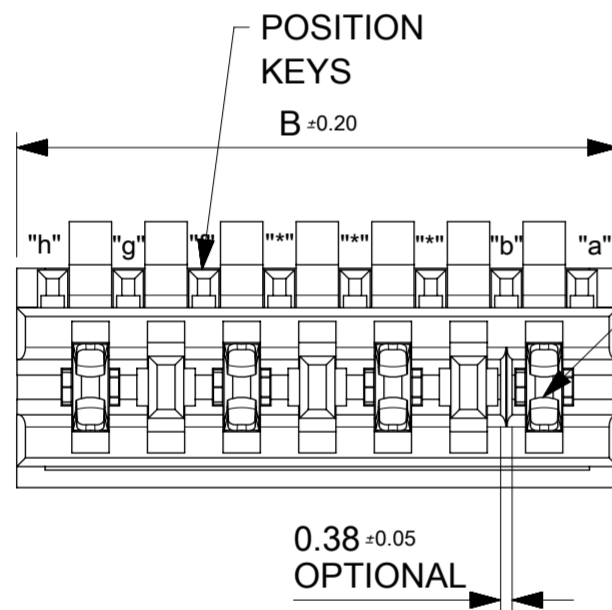

CIRCUIT 1

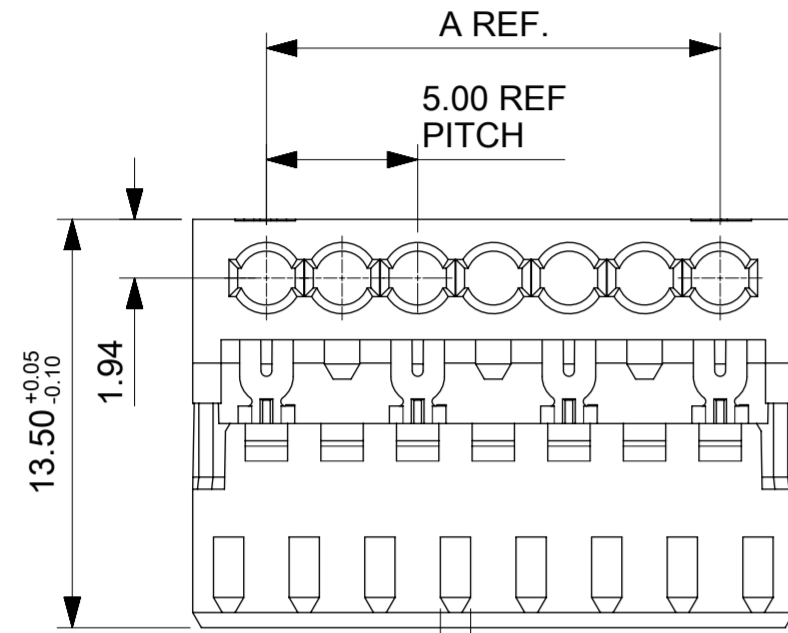
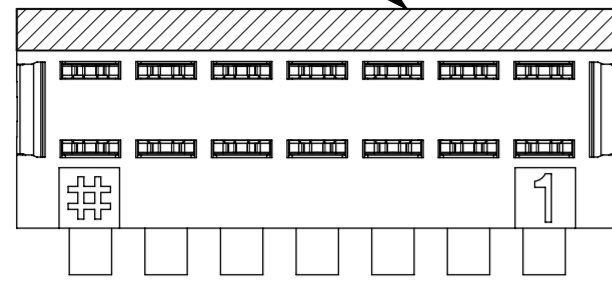
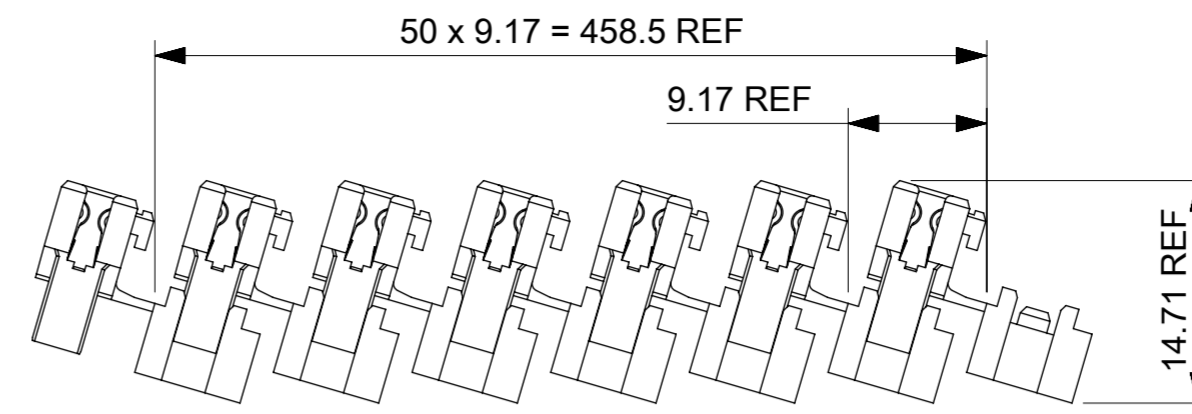

SHIPPING ARRANGEMENT

CCT	A	B
2	5.0	9.875
3	10.0	14.875
4	15.0	19.875
5	20.0	24.875
6	25.0	29.875
7	30.0	34.875
8	35.0	39.875
9	40.0	44.875
10	45.0	49.875

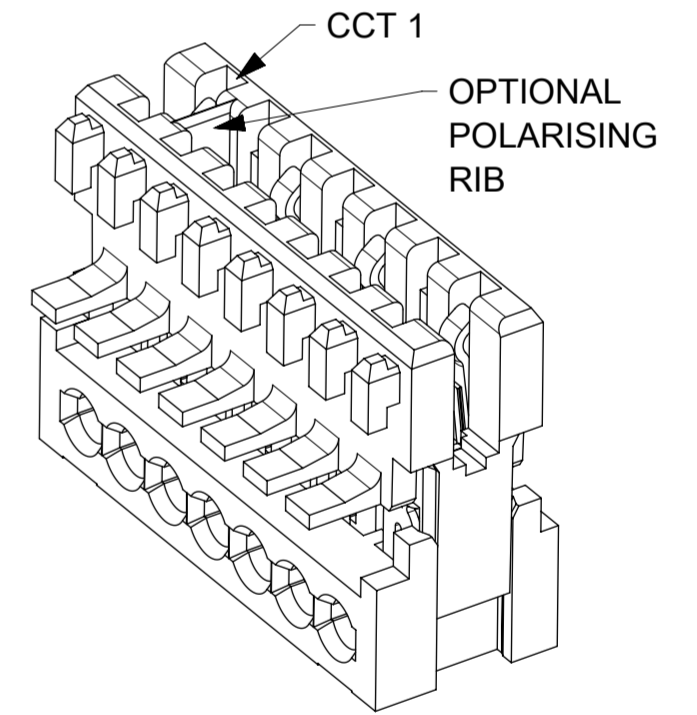
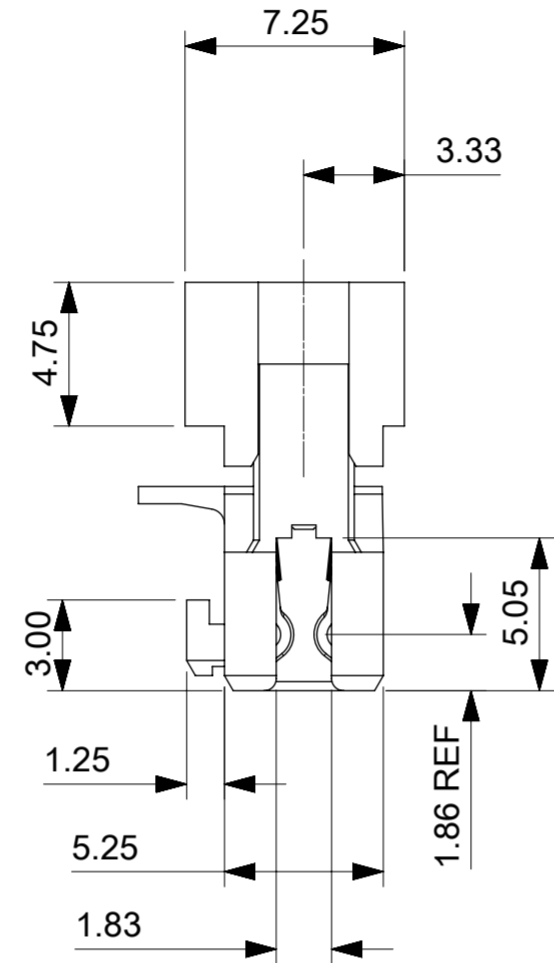

OPEN END WALLS OPTION.

NOTES:

- REFER TO PRODUCT SPECIFICATION: PS-99020-0040.
- MATERIAL: HOUSING - NYLON PA6 UL94-V0, COLOUR: NATURAL (WHITE).  
TERMINAL: PHOSPHOR BRONZE 0.30 REF. THICK - PLATING HOT TIN DIP.
- COLOUR STRIPE IS OPTIONAL. AVAILABLE IN THE FOLLOWING COLOURS: BLACK, RED, GREEN, BLUE
- REFER TO PACKAGING SPEC (PK-90871-001).
- REFER TO APPLICATION SPEC (AS-99033-0008)

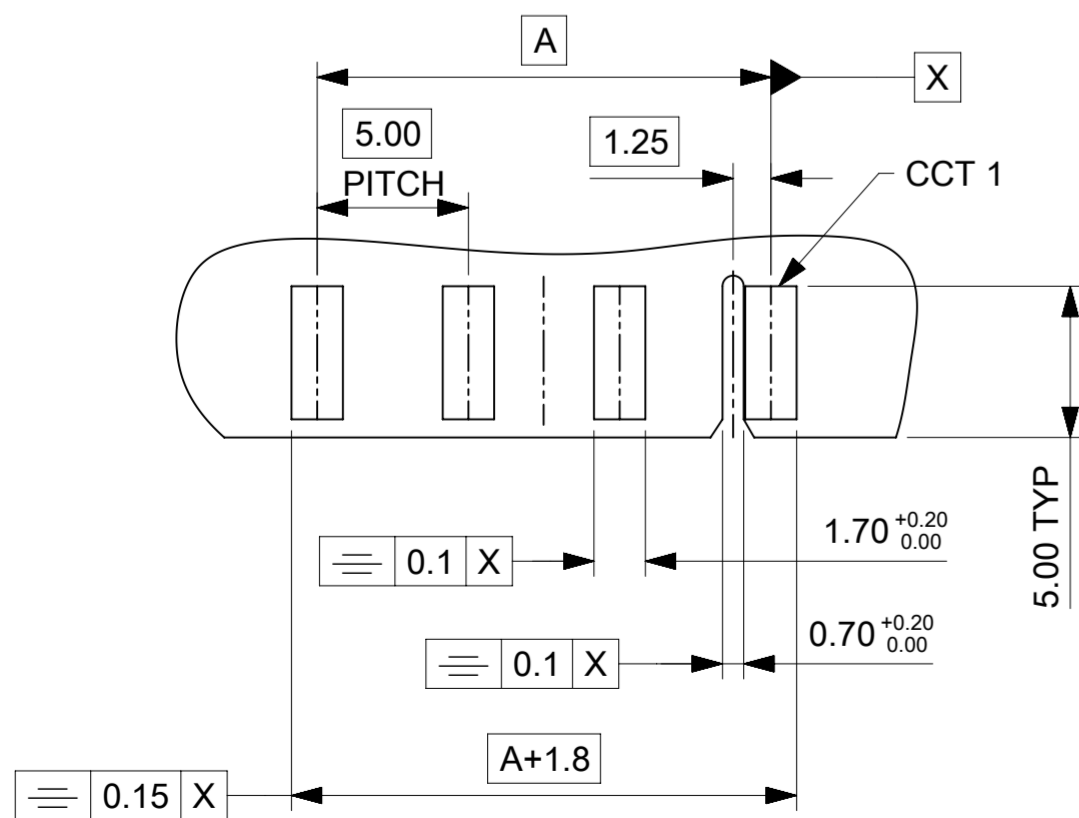

- PCB LAYOUT FOR 4CCT (5mm) CONNECTOR (WITH OPTIONAL POSITIONAL RIB SLOT BETWEEN CCT 1 & 2)  
- RECOMMENDED PCB THICKNESS 1.5±0.14MM

THIS DRAWING CONTAINS INFORMATION THAT IS PROPRIETARY TO MOLEX ELECTRONIC TECHNOLOGIES, LLC AND SHOULD NOT BE USED WITHOUT WRITTEN PERMISSION

NX - RELEASE		GENERAL TOLERANCES (UNLESS SPECIFIED)		DIMENSION UNITS		SCALE	
EC NO: 105096	2016/05/06	MM		MM			
DRWN: CFISHER01	2016/06/12	ANGULAR TOL ± 0.5 °		DRWN BY		DATE	
CHKD: CMONAHAN	2016/07/01	4 PLACES ±		CFISHER01		2016/05/06	
REV	APP: BRUTTLE	3 PLACES ± 0.05		CHKD BY		DATE	
A		2 PLACES ± 0.1		CMONAHAN		2016/06/12	
		1 PLACE ± 0.2		APPR BY		DATE	
		0 PLACES ±		BRUTTLE		2016/07/01	
DRAFT WHERE APPLICABLE MUST REMAIN WITHIN DIMENSIONS		DRAWING SIZE		THIRD ANGLE PROJECTION		PRODUCT CUSTOMER DRAWING	
		A2		SERIES		MATERIAL NUMBER	
				91717		CUSTOMER	
				DOCUMENT NUMBER		DOC TYPE	
				917170001		PSD	
				DOC PART		SHEET NUMBER	
				000		1 OF 4	

2 CIRCUIT							
PART NUMBER	HOUSING USED	REMOVED POSITION KEYS	CONFIGURATION	FIRST ENDWALL	LAST ENDWALL	POLARIZING RIB BETWEEN	COLOUR STRIPE
91717-0002	91715-0003	NONE		OPEN	OPEN	NONE	NONE
91717-0003	91715-0003	a		OPEN	OPEN	NONE	NONE
91717-0004	91715-0003	b		OPEN	OPEN	NONE	NONE
91717-0005	91715-0003	c		OPEN	OPEN	NONE	NONE
91717-0006	91715-0003	d		OPEN	OPEN	NONE	NONE
91717-0007	91715-0003	b d		OPEN	OPEN	NONE	NONE
91717-0008	91715-0003	a c		OPEN	OPEN	NONE	NONE
91717-0009	91715-0003	a d		OPEN	OPEN	NONE	NONE
91717-0010	91715-0003	a b		OPEN	OPEN	NONE	NONE
91717-0011	91715-0003	b c		OPEN	OPEN	NONE	NONE
91717-0012	91715-0003	c d		OPEN	OPEN	NONE	NONE
91717-0013	91715-0003	b c		OPEN	OPEN	NONE	RED
91717-0014	91715-0003	b c d		OPEN	OPEN	NONE	NONE
91717-0015	91715-0003	b c d		OPEN	OPEN	NONE	BLUE
91717-0016	91715-0003	c d		OPEN	OPEN	NONE	BLUE
91717-0017	91715-0203	NONE		OPEN	OPEN	CCT 2&3	NONE
91717-0018	91715-0103	NONE		OPEN	OPEN	CCT 1&2	NONE
91717-0019	91715-0003	NONE		OPEN	OPEN	NONE	BLUE
91717-0020	91715-0003	a c		OPEN	OPEN	NONE	BLUE
91717-0021	91715-0003	b c		OPEN	OPEN	NONE	GREEN
91717-0022	91715-0003	a d		OPEN	OPEN	NONE	GREEN
91717-0023	91715-0003	NONE		OPEN	OPEN	NONE	GREEN
91717-0024	91715-0103	d		OPEN	OPEN	CCT 1&2	RED
91717-0025	91715-0103	a c		OPEN	OPEN	CCT 1&2	RED
91717-0026	91715-0203	a		OPEN	OPEN	CCT 2&3	NONE
91717-0027	91715-0203	NONE		OPEN	OPEN	CCT 2&3	RED
91717-0028	91715-0003	a		OPEN	OPEN	NONE	RED
91717-0029	91715-0003	NONE		OPEN	OPEN	NONE	RED
91717-0030	91715-0103	b c d		OPEN	OPEN	CCT 1&2	RED
91717-0031	91715-0203	a		OPEN	OPEN	CCT 2&3	RED

2 CIRCUIT (CONT)							
PART NUMBER	HOUSING USED	REMOVED POSITION KEYS	CONFIGURATION	FIRST ENDWALL	LAST ENDWALL	POLARIZING RIB BETWEEN	COLOUR STRIPE
91717-0032	91715-0003	b		OPEN	OPEN	NONE	RED
91717-0033	91715-0003	d		OPEN	OPEN	NONE	YELLOW
91717-0035	91715-0003	b d		OPEN	OPEN	NONE	GREEN
91717-0036	91715-0103	NONE		OPEN	OPEN	CCT 1&2	RED
91717-0037	91715-0103	b d		OPEN	OPEN	CCT 1&2	RED
91717-0038	91715-0203	a c		OPEN	OPEN	CCT 2&3	NONE
91717-0039	91715-0003	a b d		OPEN	OPEN	NONE	NONE
91717-0040	91715-0003	a		OPEN	OPEN	NONE	BLUE

NOTES

- + DENOTES TERMINAL VOIDED POSITION  
⊕ DENOTES TERMINAL LOADED POSITION  
| DENOTES POLARIZING RIB POSITION
- MOLEX HOUSING NO. FOR REFERENCE ONLY

THIS DRAWING CONTAINS INFORMATION THAT IS PROPRIETARY TO MOLEX ELECTRONIC TECHNOLOGIES, LLC AND SHOULD NOT BE USED WITHOUT WRITTEN PERMISSION

NX - RELEASE EC NO: 105096 DRWN: CFISHER01 CHKD: CMONAHAN APPR: BRUTTLE	2016/05/06 2016/06/12 2016/07/01	GENERAL TOLERANCES (UNLESS SPECIFIED) ANGULAR TOL ± 0.5 °	DIMENSION UNITS: MM SCALE:			
	DRWN BY: CFISHER01 DATE: 2016/05/06	4 PLACES ± 3 PLACES ± 0.05 2 PLACES ± 0.1 1 PLACE ± 0.2 0 PLACES ±	DRWN BY: CFISHER01 DATE: 2016/05/06		APPLI-MATE 2.5 FEMALE 5MM TERMINAL PITCH (MATL: NYLON PA6)	
	CHKD BY: CMONAHAN DATE: 2016/06/12	2 PLACES ± 0.1 1 PLACE ± 0.2 0 PLACES ±	APPR BY: BRUTTLE DATE: 2016/07/01			PRODUCT CUSTOMER DRAWING
	DRAFT WHERE APPLICABLE MUST REMAIN WITHIN DIMENSIONS	DRAWING SIZE: A2 THIRD ANGLE PROJECTION	SERIES: 91717 MATERIAL NUMBER: 917170001 CUSTOMER:			

3 CIRCUIT							
PART NUMBER	HOUSING USED	REMOVED POSITION KEYS	CONFIGURATION	FIRST ENDWALL	LAST ENDWALL	POLARIZING RIB BETWEEN	COLOUR STRIPE
91717-1001	91715-0005	NONE		OPEN	OPEN	NONE	NONE
91717-1002	91715-0005	b		OPEN	OPEN	NONE	NONE
91717-1003	91715-0005	c		OPEN	OPEN	NONE	NONE
91717-1004	91715-0005	c d e		OPEN	OPEN	NONE	NONE
91717-1005	91715-0405	NONE		OPEN	OPEN	CCT 4&5	NONE
91717-1007	91715-0105	NONE		OPEN	OPEN	CCT 1&2	NONE
91717-1008	91715-0005	d e f		OPEN	OPEN	NONE	RED
91717-1009	91715-0005	a b c		OPEN	OPEN	NONE	RED
91717-1010	91715-0005	a c d e		OPEN	OPEN	NONE	NONE
91717-1011	91715-0005	a c d e		OPEN	OPEN	NONE	BLUE
91717-1012	91715-0005	b c d e		OPEN	OPEN	NONE	NONE
91717-1013	91715-0005	a c e		OPEN	OPEN	NONE	NONE
91717-1014	91715-0005	a e		OPEN	OPEN	NONE	NONE
91717-1015	91715-0005	a e		OPEN	OPEN	NONE	BLACK
91717-1016	91715-0005	d e f		OPEN	OPEN	NONE	NONE
91717-1017	91715-0005	NONE		OPEN	OPEN	NONE	GREEN
91717-1018	91715-0005	d f		OPEN	OPEN	NONE	NONE
91717-1019	91715-0425	NONE		CLOSED	CLOSED	CCT 4&5	NONE
91717-1020	91715-0005	d		OPEN	OPEN	NONE	NONE

4 CIRCUIT							
PART NUMBER	HOUSING USED	REMOVED POSITION KEYS	CONFIGURATION	FIRST ENDWALL	LAST ENDWALL	POLARIZING RIB BETWEEN	COLOUR STRIPE
91717-2001	91715-0007	NONE		OPEN	OPEN	NONE	NONE
91717-2002	91715-0007	a		OPEN	OPEN	NONE	NONE
91717-2003	91715-0007	b		OPEN	OPEN	NONE	NONE
91717-2004	91715-0007	d f		OPEN	OPEN	NONE	NONE
91717-2005	91715-0007	a e g		OPEN	OPEN	NONE	RED
91717-2006	91715-0007	c e		OPEN	OPEN	NONE	NONE
91717-2007	91715-0007	a b d e g		OPEN	OPEN	NONE	NONE
91717-2008	91715-0007	NONE		OPEN	OPEN	NONE	BLUE
91717-2009	91715-0007	a d g		OPEN	OPEN	NONE	BROWN
91717-2010	91715-0007	a b f g h		OPEN	OPEN	NONE	BROWN
91717-2011	91715-0007	NONE		OPEN	OPEN	NONE	GREEN
91717-2014	91715-0007	a c f		OPEN	OPEN	NONE	NONE

NOTES

- + DENOTES TERMINAL VOIDED POSITION  
⊕ DENOTES TERMINAL LOADED POSITION  
| DENOTES POLARIZING RIB POSITION
- MOLEX HOUSING NO. FOR REFERENCE ONLY

THIS DRAWING CONTAINS INFORMATION THAT IS PROPRIETARY TO MOLEX ELECTRONIC TECHNOLOGIES, LLC AND SHOULD NOT BE USED WITHOUT WRITTEN PERMISSION

NX - RELEASE EC NO: 105096 DRWN: CFISHER01 CHKD: CMONAHAN REV / APPR: BRUTTLE	2016/05/06	2016/06/12	2016/07/01	GENERAL TOLERANCES (UNLESS SPECIFIED)	DIMENSION UNITS	SCALE			
				ANGULAR TOL ± 0.5 °	MM				
				4 PLACES ±	DRWN BY	DATE			
				3 PLACES ± 0.05	CFISHER01	2016/05/06			
			2 PLACES ± 0.1	CHK'D BY	DATE	APPLI-MATE 2.5 FEMALE 5MM TERMINAL PITCH (MATL: NYLON PA6)			
			1 PLACE ± 0.2	CMONAHAN	2016/06/12				
			0 PLACES ±	APPR BY	DATE				
			DRAFT WHERE APPLICABLE MUST REMAIN WITHIN DIMENSIONS	BRUTTLE	2016/07/01				
				DRAWING SIZE	THIRD ANGLE PROJECTION	PRODUCT CUSTOMER DRAWING			
				A2		SERIES	MATERIAL NUMBER	CUSTOMER	
						91717			
						DOCUMENT NUMBER	DOC TYPE	DOC PART	SHEET NUMBER
						917170001	PSD	000	3 OF 4

5 CIRCUIT							
PART NUMBER	HOUSING USED	REMOVED POSITION KEYS	CONFIGURATION	FIRST ENDWALL	LAST ENDWALL	POLARIZING RIB BETWEEN	COLOUR STRIPE
91717-3001	91715-0009	NONE		OPEN	OPEN	NONE	NONE
91717-3002	91715-0009	b c g h i		OPEN	OPEN	NONE	GREEN
91717-3003	91715-0009	ALL		OPEN	OPEN	NONE	NONE
91717-3004	91715-0009	NONE		OPEN	OPEN	NONE	RED

6 CIRCUIT							
PART NUMBER	HOUSING USED	REMOVED POSITION KEYS	CONFIGURATION	FIRST ENDWALL	LAST ENDWALL	POLARIZING RIB BETWEEN	COLOUR STRIPE
91717-4001	91715-0011	NONE		OPEN	OPEN	NONE	NONE
91717-4002	91715-0011	b c d e f g h i k		OPEN	OPEN	NONE	NONE
91717-4003	91715-0011	NONE		OPEN	OPEN	NONE	GREEN

7 CIRCUIT							
PART NUMBER	HOUSING USED	REMOVED POSITION KEYS	CONFIGURATION	FIRST ENDWALL	LAST ENDWALL	POLARIZING RIB BETWEEN	COLOUR STRIPE
91717-5001	91715-0013	a c e g i k m		OPEN	OPEN	NONE	NONE

8 CIRCUIT							
PART NUMBER	HOUSING USED	REMOVED POSITION KEYS	CONFIGURATION	FIRST ENDWALL	LAST ENDWALL	POLARIZING RIB BETWEEN	COLOUR STRIPE
91717-6001	91715-0015	NONE		OPEN	OPEN	NONE	NONE

9 CIRCUIT							
PART NUMBER	HOUSING USED	REMOVED POSITION KEYS	CONFIGURATION	FIRST ENDWALL	LAST ENDWALL	POLARIZING RIB BETWEEN	COLOUR STRIPE
91717-7001	91715-0017	NONE		OPEN	OPEN	NONE	NONE

10 CIRCUIT							
PART NUMBER	HOUSING USED	REMOVED POSITION KEYS	CONFIGURATION	FIRST ENDWALL	LAST ENDWALL	POLARIZING RIB BETWEEN	COLOUR STRIPE
91717-8001	91715-0019	NONE		OPEN	OPEN	NONE	NONE

NOTES

- + DENOTES TERMINAL VOIDED POSITION
- ⊕ DENOTES TERMINAL LOADED POSITION
- | DENOTES POLARIZING RIB POSITION
- MOLEX HOUSING NO. FOR REFERENCE ONLY

THIS DRAWING CONTAINS INFORMATION THAT IS PROPRIETARY TO MOLEX ELECTRONIC TECHNOLOGIES, LLC AND SHOULD NOT BE USED WITHOUT WRITTEN PERMISSION

NX - RELEASE EC NO: 105096 DRWN: CFISHER01 CHKD: CMONAHAN REV APPR: BRUTTLE	2016/05/06 2016/06/12 2016/07/01	GENERAL TOLERANCES (UNLESS SPECIFIED) ANGULAR TOL ± 0.5 °	DIMENSION UNITS: MM SCALE:	
	4 PLACES ± 3 PLACES ± 0.05 2 PLACES ± 0.1 1 PLACE ± 0.2 0 PLACES ±	DRWN BY: CFISHER01 DATE: 2016/05/06 CHKD BY: CMONAHAN DATE: 2016/06/12 APPR BY: BRUTTLE DATE: 2016/07/01	APPLI-MATE 2.5 FEMALE 5MM TERMINAL PITCH (MATL: NYLON PA6)	
	DRAFT WHERE APPLICABLE MUST REMAIN WITHIN DIMENSIONS	DRAWING SIZE: A2 THIRD ANGLE PROJECTION	PRODUCT CUSTOMER DRAWING SERIES: 91717 MATERIAL NUMBER: 917170001 CUSTOMER:	
	A	DOCUMENT NUMBER: 917170001 DOC TYPE: PSD DOC PART: 000 SHEET NUMBER: 4 OF 4		