

NOTES:

- 1- MATERIAL: PA 6.6 BLACK heat stabilized.
- 2- DELIVERED PRODUCT WEIGHT: 5.0 g.
- 3- RELATED COUNTERPART FEMALE CONNECTORS (48 WAYS).

MARKINGS:

- 1** Supplier identification.
- 3** Date: MONTH/YEAR.
- 4** Material.
- 5** Mould identification M1 or M2.
- 6** Print identification (number).
- 7** Revision level

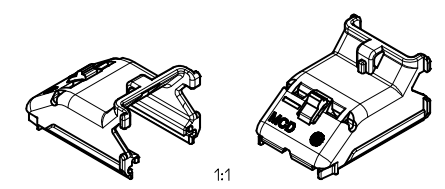
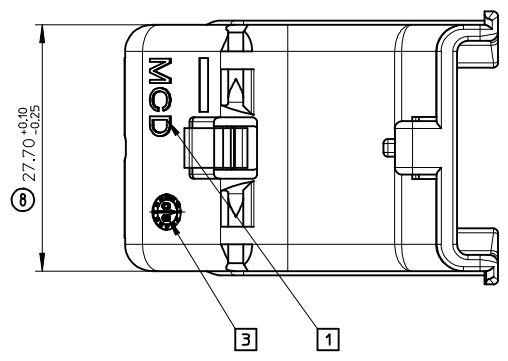
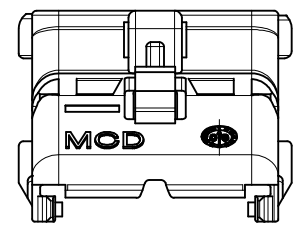
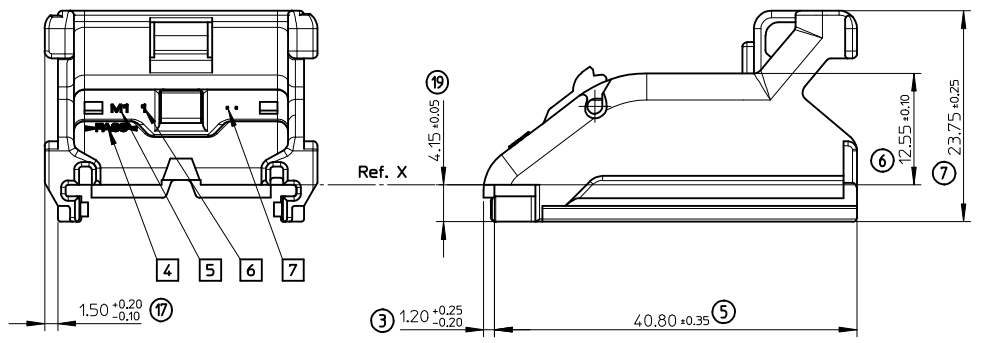
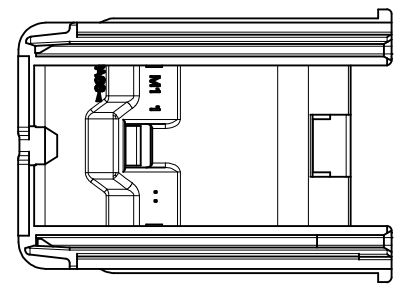

REVISED EC NO: G2015-0147 DRW: PBOUAIN 2015/02/12 CHK: APLESSIS 2015/02/12 APPR: CBOUCHAN 2015/03/03 D	DESCRIPTION WIRE CAP 48 WAY MAT SEAL VERSION	QUALITY SYMBOLS (Symbol: Inverted triangle with circle) (Symbol: Inverted triangle with circle) (Symbol: Inverted triangle with circle)		GENERAL TOLERANCES (UNLESS SPECIFIED)		DIMENSION STYLE MM ONLY		SCALE 2.5:1	DESIGN UNITS METRIC	FIRST ANGLE PROJECTION		
		4 PLACES	±	---	±	---	DRAWN BY PGRANDCL	DATE 2013/04/16	TITLE WIRE CAP 48 WAY MAT SEAL VERSION molex DOCUMENT NO. SD-64320-002 SHEET NO. 1 OF 1			
		3 PLACES	±	---	±	---	CHECKED BY JDUCLOS	DATE 2013/04/16				
		2 PLACES	±	---	±	---	APPROVED BY CBOUCHAN	DATE 2014/02/03				
1 PLACE	±	---	±	---	MATERIAL NO. 0643201301	DOCUMENT NO. SD-64320-002						
0 PLACE	±	---	±	---	ANGULAR ±---° DRAFT WHERE APPLICABLE MUST REMAIN WITHIN DIMENSIONS		SIZE A2		THIS DRAWING CONTAINS INFORMATION THAT IS PROPRIETARY TO MOLEX INCORPORATED AND SHOULD NOT BE USED WITHOUT WRITTEN PERMISSION			