

13	12	11	10	9	8	7	6	5	4	3	2	1
ASSEMBLY NUMBER		FINISH										
73656-0000		SEE NOTE 2.										
73656-0001		SEE NOTE 3.										

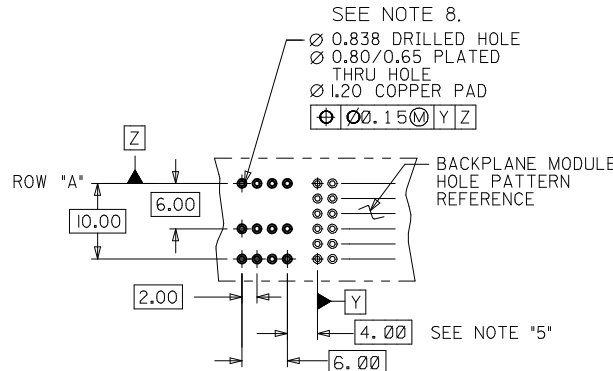
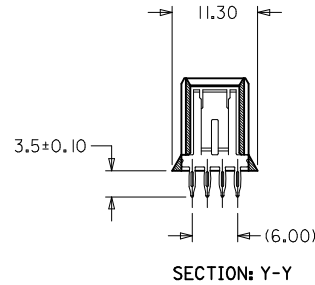
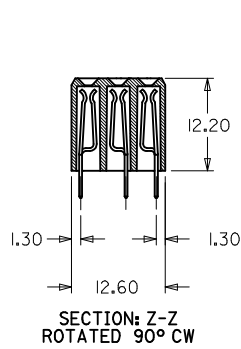
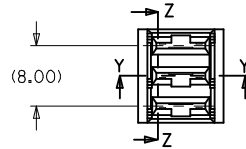
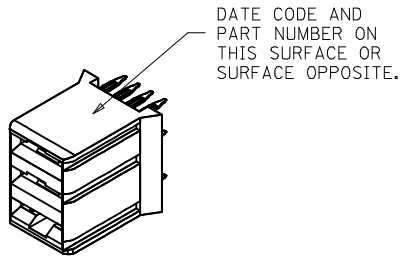

PCB LAYOUT: COMPONENT SIDE  
RECOMMENDED PCB THICKNESS: 2.50 MIN

NOTES:

1. MATERIALS: HOUSING - LIQUID CRYSTAL POLYMER (LCP), GLASS-FILLED, UL94V-0, COLOR: BLACK  
TERMINAL - COPPER ALLOY
2. FINISH: SELECTIVE GOLD (Au) IN CONTACT AREA, 0.76 micrometer MINIMUM THICKNESS: NICKEL (Ni) AND GOLD FLASH OVERALL
3. FINISH: SELECTIVE GOLD (Au) IN CONTACT AREA, 0.76 micrometer MINIMUM THICKNESS: MATTE TIN (Sn) OVER NICKEL (Ni) IN COMPLIANT AREA: NICKEL (Ni) OVERALL ON REMAINING WITH SELECTIVE GOLD (Au) FLASH.
4. THIS DIMENSION MUST BE A MULTIPLE OF 4.00 mm.
5. DIMENSIONS ARE IN MILLIMETERS.
6. THIS PART CONFORMS TO MOLEX PRODUCT SPECIFICATION PS-73670-9999.
7. PACKAGE ASSEMBLIES PER PK-70873-0819.
8. HOLE SIZE SPECIFICATION IS FOR TIN/LEAD PLATED HOLES ONLY. FOR OTHER PLATING TYPES SEE MOLEX APPLICATION AS-73670-9996.
9. THIS PART CONFORMS TO MOLEX COSMETIC SPECIFICATION PS-45499-002 CLASS B.

LEAD FREE CONVERSION EC NO: UCP2013-3253 DRAWN:WHIPPLE 2013/02/04 CHKD:WOLFE 2013/02/04 APPR:SMILLER 2013/08/05	QUALITY SYMBOLS ▽=0 ▽=0 ▽=0	GENERAL TOLERANCES (UNLESS SPECIFIED)		DIMENSION STYLE <b>MM ONLY</b>		SCALE <b>1:1</b>	DESIGN UNITS <b>METRIC</b>	THIRD ANGLE PROJECTION	
		mm	INCH	DRAWN BY ELO	DATE 1998/05/21	TITLE <b>SALES ASSY , HDM BACKPLANE POWER MODULE (PRESSFIT)</b>		SHEET NO. 1 OF 4	
REV I	DESCRIPTION	4 PLACES	± ---	± ---	CHECKED BY SMR	DATE 1998/05/21	<b>molex</b>		DOCUMENT NO. <b>SDA-73656-*00*</b>
		3 PLACES	± ---	± ---	APPROVED BY CAB	DATE 1998/05/21			
ANGULAR ±1/2°		DRAFT WHERE APPLICABLE MUST REMAIN WITHIN DIMENSIONS		MATERIAL NO. <b>SEE TABLE</b>		THIS DRAWING CONTAINS INFORMATION THAT IS PROPRIETARY TO MOLEX INCORPORATED AND SHOULD NOT BE USED WITHOUT WRITTEN PERMISSION			

10 9 8 7 6 5 4 3 2 1

DATE CODE AND  
PART NUMBER ON  
THIS SURFACE OR  
SURFACE OPPOSITE.

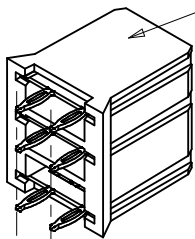

73656-100\*

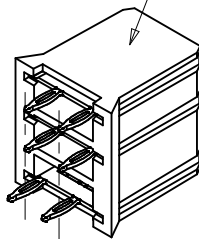

73656-200\*

### MIDPLANE OPTION

ASSEMBLY NUMBER	FINISH (SEE SHT 1)
73656-1000	SEE NOTE 2. (GOLD TAILS)
73656-2000	
73656-1001	SEE NOTE 3. *(MATTE TIN TAILS)
73656-2001	

\* FORMERLY TIN/LEAD

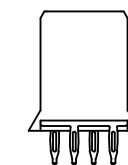
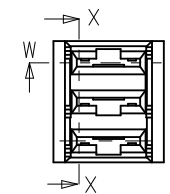
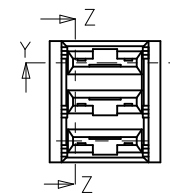

73656-200\*

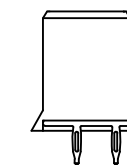

73656-100\*

USE BACKPLANE MODULE  
HOLE REFERENCE PATTERN  
FROM SHEET 1

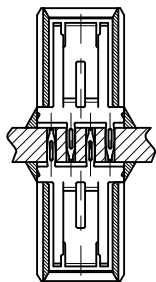

BACK-TO-BACK  
MOUNTING APPLICATION

3.50  
MIN

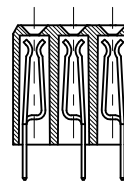

SECTION X-X  
SECTION Z-Z  
ROTATED 90° CW

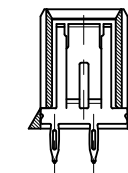

(4.00)  
SECTION: Y-Y

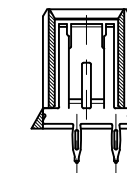

(4.00)  
SECTION: W-W

SEE SHEET 1	EC NO: UCP2013-3253	QUALITY SYMBOLS	GENERAL TOLERANCES (UNLESS SPECIFIED)	DIMENSION STYLE		SCALE	DESIGN UNITS	THIRD ANGLE PROJECTION	
	DRWN:RWHIPPLE 2013/02/04	▽=0	mm INCH	MM ONLY		1:1	METRIC	SALES ASSY, HDM BACKPLANE POWER MODULE (PRESSFIT)	
	CHKD:MMOLFE 2013/02/04	▽=0	4 PLACES ± --- ± ---	DRAWN BY	DATE	TITLE	<div style="text-align: center;"><b>molex</b></div>		
	APPR:SMILLER 2013/08/05	▽=0	3 PLACES ± --- ± ---	ELO	1998/05/21	SDA-73656-*00*			
		2 PLACES ± 0.13 ± ---	1 PLACE ± 0.25 ± ---	0 PLACE ± --- ± ---	CHECKED BY	DATE	2 OF 4		
		ANGULAR ± 1/2°	DRAFT WHERE APPLICABLE	MATERIAL NO.	APPROVED BY	DATE	THIS DRAWING CONTAINS INFORMATION THAT IS PROPRIETARY TO MOLEX INCORPORATED AND SHOULD NOT BE USED WITHOUT WRITTEN PERMISSION		
		WITHIN DIMENSIONS		SEE TABLE	CAB	1998/05/21			

9 8 7 6 5 4 3 2 1

10	9	8	7	6	5	4	3	2	1
ASSEMBLY NUMBER		FINISH (SHT 1)							
73656-5000		SEE NOTE 2.							
73656-5001		SEE NOTE 3.							

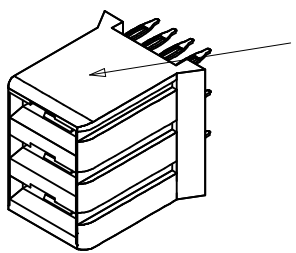

DATE CODE AND PART NUMBER ON THIS SURFACE OR SURFACE OPPOSITE.

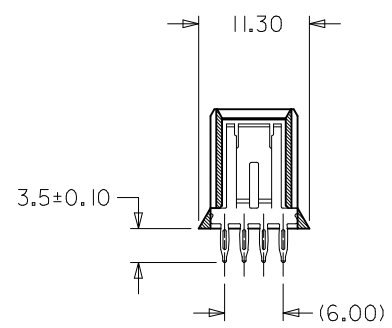
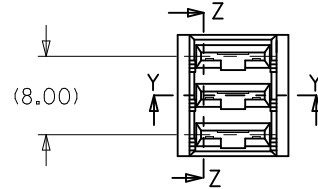

SECTION: Y-Y

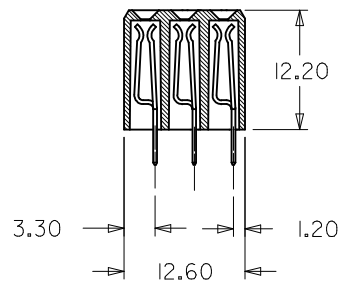

SECTION: Z-Z ROTATED 90° CW

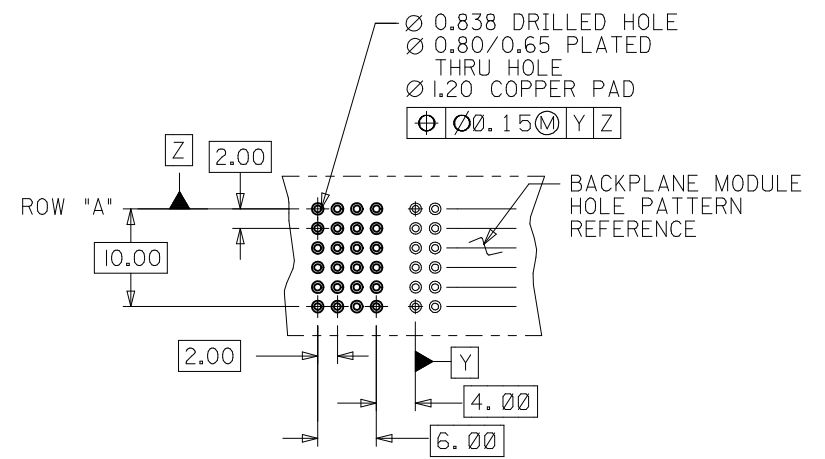
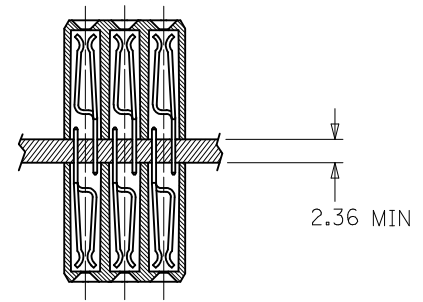

BACKPLANE MODULE HOLE PATTERN REFERENCE

<b>SEE SHEET 1</b> EC NO: UCP2013-3253 DRW:RHH/PPLE 2013/02/04 CHKD:MMOLFE 2013/02/04 APPR:SMILLER 2013/08/05	QUALITY SYMBOLS	GENERAL TOLERANCES (UNLESS SPECIFIED)	DIMENSION STYLE	SCALE	DESIGN UNITS	THIRD ANGLE PROJECTION																		
	$\nabla = 0$ $\nabla = 0$ $\nabla = 0$	<table border="1"> <tr> <th></th> <th>mm</th> <th>INCH</th> </tr> <tr> <td>4 PLACES</td> <td>± ---</td> <td>± ---</td> </tr> <tr> <td>3 PLACES</td> <td>± ---</td> <td>± ---</td> </tr> <tr> <td>2 PLACES</td> <td>± 0.13</td> <td>± ---</td> </tr> <tr> <td>1 PLACE</td> <td>± 0.25</td> <td>± ---</td> </tr> <tr> <td>0 PLACE</td> <td>± ---</td> <td>± ---</td> </tr> </table>		mm	INCH	4 PLACES	± ---	± ---	3 PLACES	± ---	± ---	2 PLACES	± 0.13	± ---	1 PLACE	± 0.25	± ---	0 PLACE	± ---	± ---	MM ONLY	1:1	METRIC	
		mm	INCH																					
	4 PLACES	± ---	± ---																					
3 PLACES	± ---	± ---																						
2 PLACES	± 0.13	± ---																						
1 PLACE	± 0.25	± ---																						
0 PLACE	± ---	± ---																						
DESCRIPTION	ANGULAR ±1/2° DRAFT WHERE APPLICABLE MUST REMAIN WITHIN DIMENSIONS	DRAWN BY DATE ELO 1998/05/21 CHECKED BY DATE SMR 1998/05/21 APPROVED BY DATE CAB 1998/05/21	TITLE	SALES ASSY, HDM BACKPLANE POWER MODULE (PRESSFIT)	MATERIAL NO. SEE TABLE	DOCUMENT NO. SDA-73656-*00*	SHEET NO. 3 OF 4																	
REV			SIZE B	THIS DRAWING CONTAINS INFORMATION THAT IS PROPRIETARY TO MOLEX INCORPORATED AND SHOULD NOT BE USED WITHOUT WRITTEN PERMISSION																				

10	9	8	7	6	5	4	3	2	1
ASSEMBLY NUMBER		FINISH							
73656-0180		SEE NOTE 2.							
73656-0181		SEE NOTE 3.							

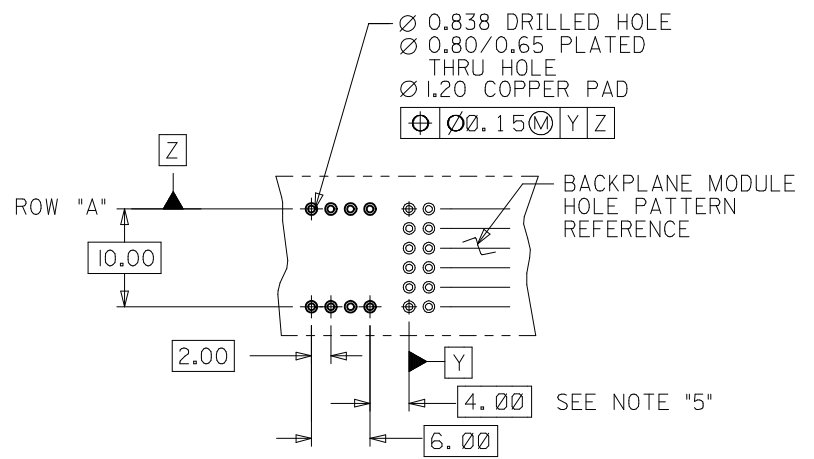
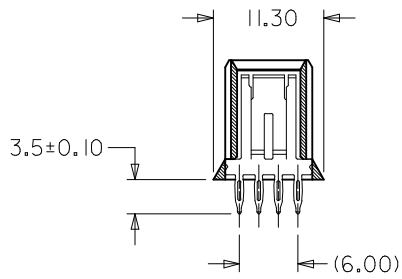
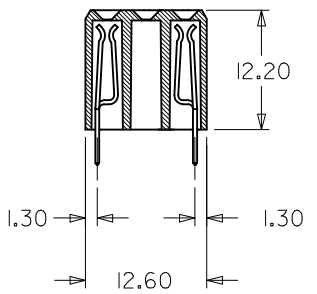
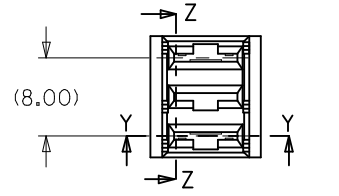
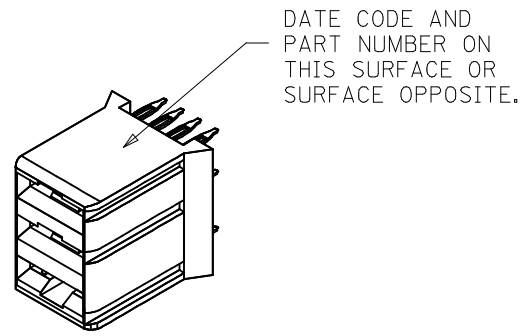

PCB LAYOUT: COMPONENT SIDE  
RECOMMENDED PCB THICKNESS: 2.50 MIN

SEE SHEET 1 EC NO: UCP2013-3253 DRWN:RWH/PPLE 2013/02/04 CHKD:MM/LFE 2013/02/04 APPR:SMILLER 2013/08/05	QUALITY SYMBOLS	GENERAL TOLERANCES (UNLESS SPECIFIED)	DIMENSION STYLE	SCALE	DESIGN UNITS	THIRD ANGLE PROJECTION	
	▽=0	mm INCH	MM ONLY	1:1	METRIC	⊕	
	▽=0	4 PLACES ± --- ± ---	DRAWN BY DATE	ELO 1998/05/21	TITLE SALES ASSY, HDM BACKPLANE POWER MODULE (PRESSFIT)		
	▽=0	3 PLACES ± --- ± ---	CHECKED BY DATE	SMR 1998/05/21			
	▽=0	2 PLACES ± 0.13 ± ---	APPROVED BY DATE	CAB 1998/05/21	<b>molex</b> DOCUMENT NO. SDA-73656-*00* SHEET NO. 4 OF 4		
▽=0	1 PLACE ± 0.25 ± ---	MATERIAL NO.	SEE TABLE				
REV	DESCRIPTION	ANGULAR ± 1/2° DRAFT WHERE APPLICABLE MUST REMAIN WITHIN DIMENSIONS	SIZE B	THIS DRAWING CONTAINS INFORMATION THAT IS PROPRIETARY TO MOLEX INCORPORATED AND SHOULD NOT BE USED WITHOUT WRITTEN PERMISSION			