



**PARA LIGHT ELECTRONICS CO., LTD.**

4F, No.1, Lane 93, Chien Yi Road, Chung Ho City, Taipei, Taiwan, R.O.C.  
Tel: 886-2-2225-3733 Fax: 886-2-2225-4800  
E-mail: [para@para.com.tw](mailto:para@para.com.tw) <http://www.para.com.tw>

DATA SHEET

PART NO. : L-6V4HURC

REV : A / 0

CUSTOMER'S APPROVAL : \_\_\_\_\_

DCC : \_\_\_\_\_

DRAWING NO. : DS-36-03-0046

DATE : 2003-06-21

Page : 1



3.1 mm DIA CYLINDRICAL LED LAMP

L-6V4HURC

REV:A / 0

PACKAGE DIMENSIONS

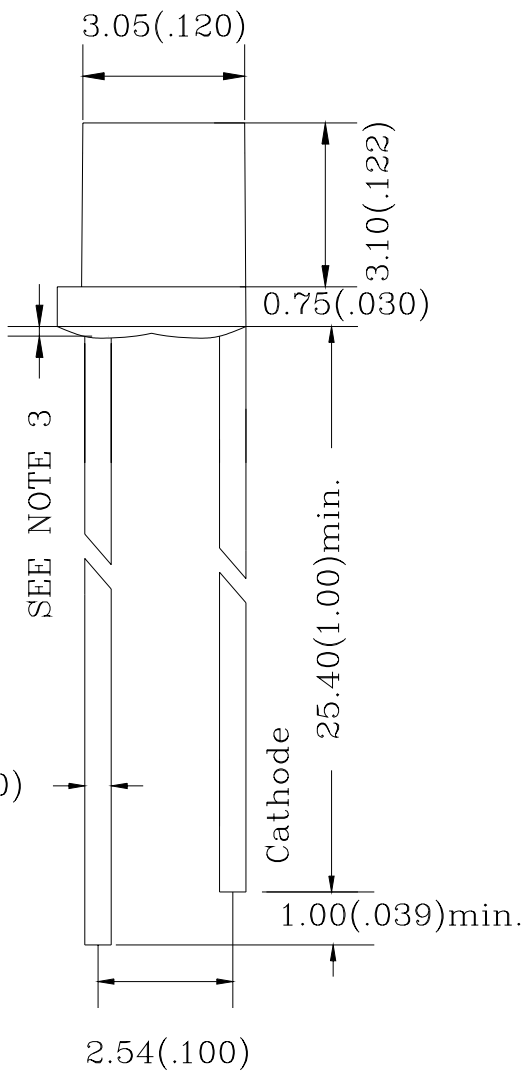
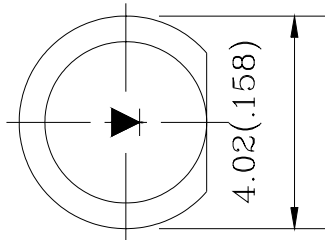

Note:

- 1. All Dimensions are in millimeters.
- 2. Tolerance is  $\pm 0.25\text{mm}$  (0.010 ") Unless otherwise specified.
- 3. Protruded resin under flange is 1.5mm (0.059 ") max.
- 4. Lead spacing is measured where the leads emerge from the package.
- 5. Specification are subject to change without notice



3.1 mm DIA CYLINDRICAL LED LAMP

L-6V4HURC

REV:A / 0

FEATURES

- \* 3.0 mm DIA CYLINDRICAL LED LAMP
- \* HIGH LUMINOUS INTENSITY OUTPUT.
- \* LOW POWER CONSUMPTION.
- \* HIGH EFFICIENCY.
- \* VERSATILE MOUNTING ON P.C. BOARD OR PANEL.
- \* I.C. COMPATIBLE.

CHIP MATERIALS

- \* Dice Material : AlGaInP/GaAs
- \* Light Color : ULTRA RED
- \* Lens Color : WATER CLEAR

ABSOLUTE MAXIMUM RATING : ( Ta = 25°C )

SYMBOL	PARAMETER	ULTRA RED	UNIT
PAD	Power Dissipation Per Chip	75	mW
VR	Reverse Voltage Per Chip	5	V
IAF	Continuous Forward Current Per Chip	30	mA
IPF	Peak Forward Current Per Chip (Duty – 0.1, 1KHz)	60	mA
–	Derating Linear From 25°C Per Chip	0.40	mA/°C
Topr	Operating Temperature Range	-25°C to 85°C	
Tstg	Storage Temperature Range	-40°C to 85°C	

Lead Soldering Temperature { 1.6mm(0.063 inch) From Body } 250°C ± 5°C for 3 Seconds

ELECTRO-OPTICAL CHARACTERISTICS : ( Ta = 25°C )

SYMBOL	PARAMETER	TEST CONDITION	MIN.	TYP.	MAX.	UNIT
VF	Forward Voltage	IF = 20mA		2.0	2.5	V
IR	Reverse Current	VR = 5V			100	µA
λD	Dominant Wavelength	IF = 20mA		633		nm
Δλ	Spectral Line Half-Width	IF = 20mA		20		nm
2θ1/2	Half Intensity Angle	IF = 20mA		110		deg
IV	Luminous Intensity	IF = 20mA		180		mcd



# 3.1 mm DIA CYLINDRICAL LED LAMP

L-6V4HURC

REV:A / 0

