

Push Back Probes



Push Back Probe 157 mil VF4

Centers (mm/mil)	4,00 / 157
Current	10,0 A
Temperature	-20°C...+80°C
R typically	30 mOhm

Spring Force (cN ±20%)

Preload	Nominal Force
80	300
100	500
300	1000
300	1500
300	2000
300	2500

Travel (mm)

Nominal	Maximum
5,0	5,5
Thread (M)	2,5x0,35
Wrench Size	2,5
Pointing Accuracy	±0,1 mm

Materials and Plating

Plunger	see Tip Style
Barrel	Brass, gold plated
Spring	Music wire, gold plated
Receptacle	Brass, Gold plated

Accessories

Insertion tool receptacle	FAWZVF4
Screw-in tool probe	FWZVF4 (T) max. Ø4,0 mm
Screw-in tool probe	FWZVF4S1 (T1) max. Ø3,1 mm

Drill Size [mm]

VF4	2,48 - 2,49
-----	-------------

Projection Height

HVF4...	40,5
---------	------

Type	Tip-Ø	Spring Force (N)
VF4 06 B 300 G 15		
Tip Style	Material	Finish
Material:	B = BeCu	
Head-Ø:	300 = 3,0 mm (e.g.)	
Finish:	G = Gold	
Special Version:	L = Long Version	
Receptacle:	Order Code according drawing	

At the Order Code of spade versions you will find a number instead of the coded tip-Ø. This number shows in the table the belonging spade dimensions.

ORDER EXAMPLE

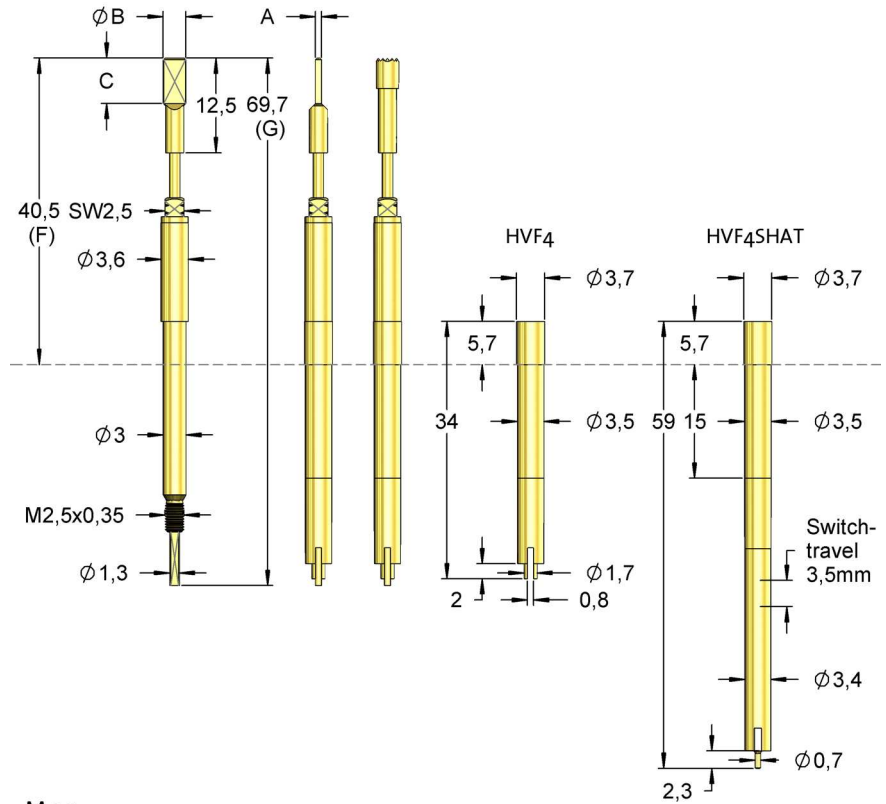

M 1:1



Tip Style	Bezeichnung	Material	Oberfläche	Ø in mm	Version
	05	B	G	2,3; 3,0; 4,0	-
	06	B	G	2,4; 3,0; 4,0; 4,8	-
	11	B	G	1,8; 2,0; 2,3; 3,0; 3,7	-
	14	S	L	3,0	-
	16	B	G	1,0; 1,4; 1,8; 2,0; 2,3	-
	17	B	G	3,0; 4,0	-
	50	B	G	3,0	-

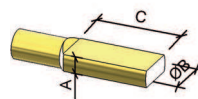

Tip Style	Number	A	B	C	D	E	F	G	Version
83	0001	0,8	2,5	6,0	-	-	40,5	69,7	-
83	0002	0,8	3,0	6,0	-	-	40,5	69,7	-
83	0003	1,6	2,25	6,0	-	-	40,5	69,7	-
83	0004	1,6	3,0	6,0	-	-	40,5	69,7	-
83	0005	1,8	2,25	6,0	-	-	40,5	69,7	-
83	0006	0,6	2,5	6,0	-	-	40,5	69,7	-
83	0007	1,3	2,25	16,0	-	-	50,5	79,7	L
83	0008	1,4	2,2	6,0	-	-	40,5	69,7	-
83	0009	1,3	2,2	6,0	-	-	40,5	69,7	-
83	0010	0,8	2,5	12,0	-	-	46,5	75,7	-