

# CSM 300N

Conduction-cooled capacitor

Technology Patented Worldwide

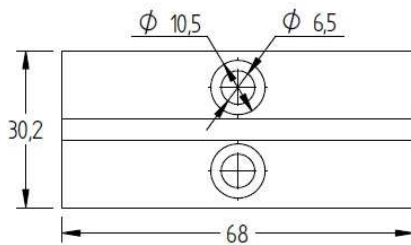
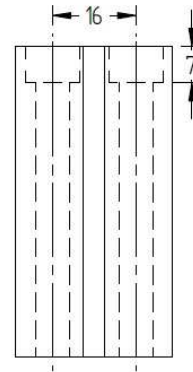
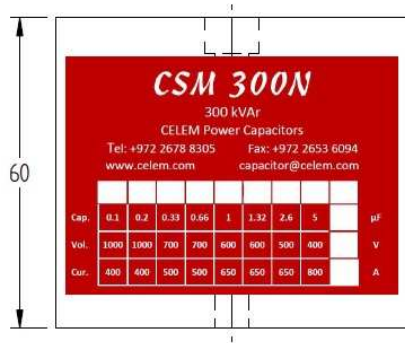

CSM300N is a replacement of the CSM300. It is a 300kVAr capacitor with same structure and dimensions as the old CSM300, but it utilizes the most advance Celem soldering technology which provides a wider power safety margin, and improves the longevity of the capacitor.

## Specifications

Type		CSM 300N							
Dimensions (L x W x H)	mm	68 x 60 x 30.2							
Weight	kg	0.55							
Capacitance (±10%)	μF	0.1μF	0.2μF	0.33μF	0.66μF	1μF	1.32μF	2.6μF	5μF
Sinusoidal Voltage	V <sub>rms</sub>	1000		700		600		500	400
Peak Voltage	V	1410		990		850		710	570
Max. Current	A <sub>rms</sub>	400		500		650		800	
Max. Power	kVA <sub>r</sub>	300							
Freq Range @ Full Power	kHz	478-849	239-425	295-402	148-201	133-224	101-170	73-86	60-68
Stray Inductance	nH	< 5							

*Celem Power Capacitors*

Produced: 04-02-2014

# CSM 300N

Conduction-cooled capacitor

Technology Patented Worldwide

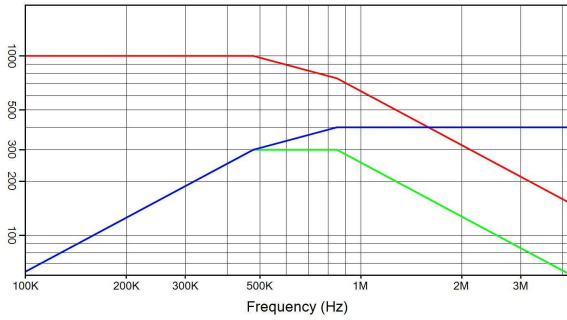

**CSM 300N 0.1  $\mu$ F 1000 V<sub>rms</sub> 400 A<sub>rms</sub> 300 kVA<sub>r</sub>**  
 I(A) — Q(kVA<sub>r</sub>) — V<sub>rms</sub> — V<sub>rms</sub>

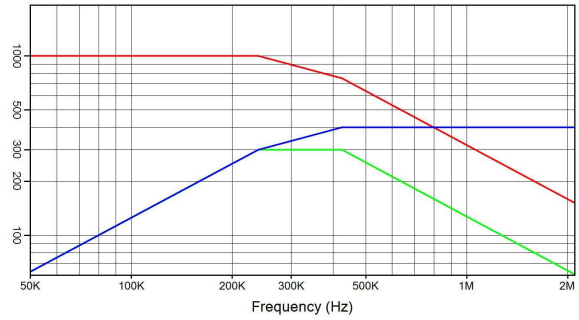

**CSM 300N 0.2  $\mu$ F 1000 V<sub>rms</sub> 400 A<sub>rms</sub> 300 kVA<sub>r</sub>**  
 I(A) — Q(kVA<sub>r</sub>) — V<sub>rms</sub> — V<sub>rms</sub>

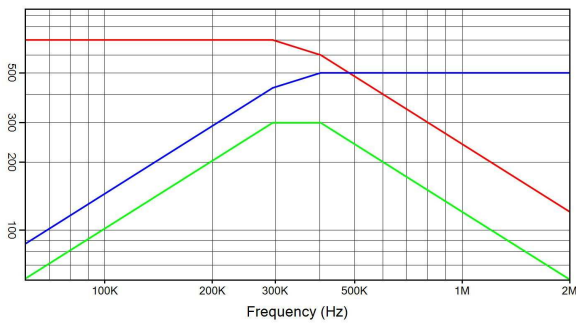

**CSM 300N 0.33  $\mu$ F 700 V<sub>rms</sub> 500 A<sub>rms</sub> 300 kVA<sub>r</sub>**  
 I(A) — Q(kVA<sub>r</sub>) — V<sub>rms</sub> — V<sub>rms</sub>

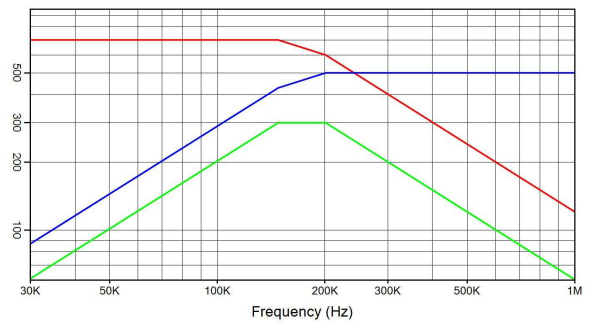

**CSM 300N 0.66  $\mu$ F 700 V<sub>rms</sub> 500 A<sub>rms</sub> 300 kVA<sub>r</sub>**  
 I(A) — Q(kVA<sub>r</sub>) — V<sub>rms</sub> — V<sub>rms</sub>

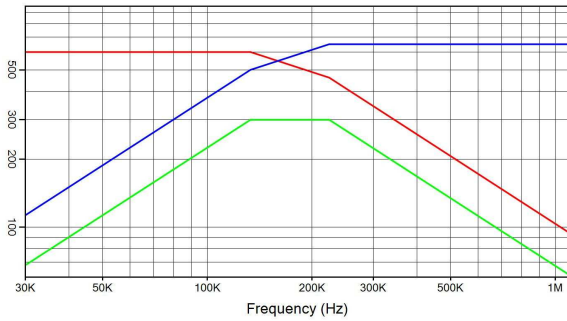

**CSM 300N 1  $\mu$ F 600 V<sub>rms</sub> 650 A<sub>rms</sub> 300 kVA<sub>r</sub>**  
 I(A) — Q(kVA<sub>r</sub>) — V<sub>rms</sub> — V<sub>rms</sub>

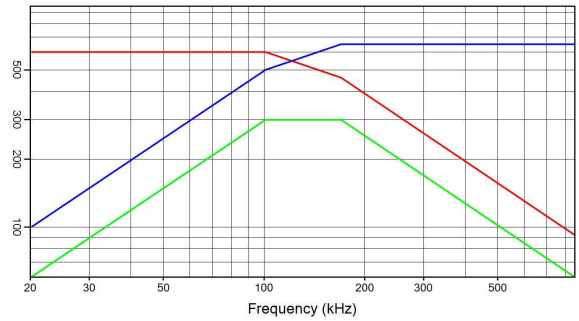

**CSM 300N 1.32  $\mu$ F 600 V<sub>rms</sub> 650 A<sub>rms</sub> 300 kVA<sub>r</sub>**  
 I(A) — Q(kVA<sub>r</sub>) — V<sub>rms</sub> — V<sub>rms</sub>

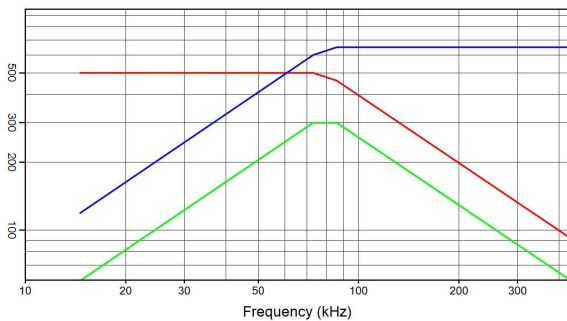

**CSM 300N 2.6  $\mu$ F 500 V<sub>rms</sub> 650 A<sub>rms</sub> 300 kVA<sub>r</sub>**  
 I(A) — Q(kVA<sub>r</sub>) — V<sub>rms</sub> — V<sub>rms</sub>

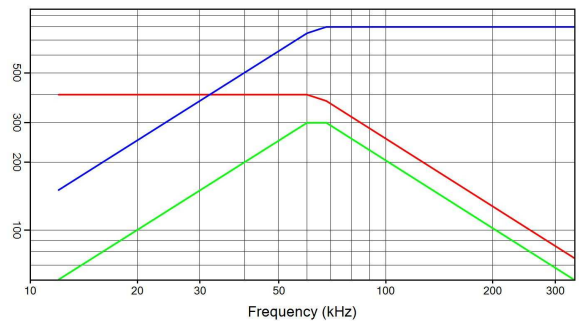

**CSM 300N 5  $\mu$ F 400 V<sub>rms</sub> 800 A<sub>rms</sub> 300 kVA<sub>r</sub>**  
 I(A) — Q(kVA<sub>r</sub>) — V<sub>rms</sub> — V<sub>rms</sub>

*Celem Power Capacitors*

Produced: 04-02-2014