

#6250

## Discharge Capacitors

PPMF 300-75.0 r K

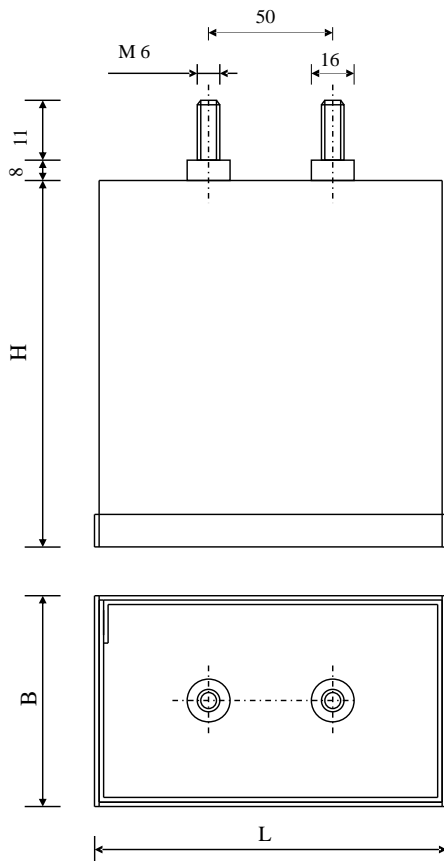

Dielectric of metallized polypropylene

Threaded outputs

Resin end sealing

Aluminium case  
thick 1.2 mm

Parameter	Symbol		Value	Unit	Condition
Capacitance	C		75	$\mu\text{F}$	1 V / 100 Hz
Tolerance			$\pm 10$	%	
Rated Voltage	Un DC		3'000	VDC	
Rated reversal Voltage	U inv.		20	%	
Default reversal Voltage	U inv. S.		80	%	
Discharge Current	I cr. max		3.5	kA	
Default Current	Is.		5.3	kA	
Maximum RMS current	I RMS		35	A	
Tangente delta	tg $\delta$		$\leq 100$	$10^{-4}$	1 V / 100 Hz
Stray inductar	ESL		$\leq 200$	nH	
Insulation resistance	Ri x C		$> 30'000$	s	500 VDC - 1 min
Test voltage between terminals	U T1		5'000	VDC	10 s
Test voltage between terminals to case	U T2		4'000	VAC	50 Hz - 1 min
Estimated operational life			$200 \times 10^6$	Cycles	2.4 kV p-p / 5.4 kA
Estimated operational life			100'000	hours	3 kVDC / 70°C

Dimension	Symbol		Unit	Conditions
Width		95	mm	
Length		116	mm	
Height		267	mm	
Thread		M6 x 11	mm	
	M1			
	M0			
	Modification	Date	Visa émetteur	

Condensateurs CH 1400 Yverdon, Switzerland  
 Kondensatoren Tel.: ++41 24 445 66 88  
 Capacitors Fax: ++41 24 445 66 89

**Lecaniché**  
**Capacitors**  
A FISCHER & TAUSSCHKE COMPANY

HJJ

www.Lcap.ch  
 16.01.2014

capinfo@Lcap.ch  
 faisab6250.XLS