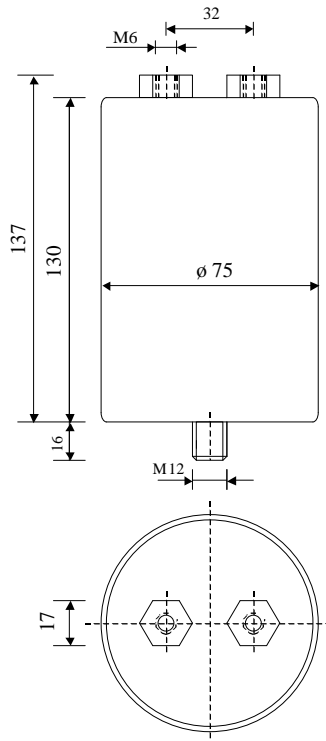

#5540

METALLIZED POLYPROPYLENE CAPACITORS

PPM 60-360.0 cv6 K

Dielectric of metallized
polypropylene

Threaded outputs

Resin end sealing

Aluminium case

Parameter	Symbol	Value	Unit	Condition
Capacitance	C	360	μF	1 V / 1 kHz
Tolerance		± 10	%	
Rated voltage	$U_n \text{ DC}$	600	VDC	
RMS Current	$I_{\text{eff max.}}$	47.1	Aeff	Temp. Amb. max 25°C
RMS Current	$I_{\text{eff max.}}$	29.2	Aeff	Temp. Amb. max 75°C
Slope of voltage variation	$du/dt \text{ max.}$	11	V/ μs	max. repetitive
Repetitive surge current	$I \text{ cr. max}$	3845	A	
Tangente delta	$\text{tg}\delta$	≤ 110	10^{-4}	1 V / 1 kHz
Equivalent serie resistance	ESR	4.6	m Ω	1 V / 10 kHz
Stray inductance	ESL	≤ 72	nH	
Insulation resistance	$R_i \times C$	$\geq 20'000$	s	300 VDC - 1 min
Test voltage between terminals	U T1	960	VDC	10 s
Test voltage terminals to case	U T2	2500	VAC	50 Hz / 1 min
Climatic category		55/105/56		

Dimension	Symbol	Value	Unit	Condition
Diameter	D	75	mm	
Height	H	130	mm	
Terminals				
Thread		M6 x 6	mm	
Thread spacing	e	32	mm	
Fixing stud		M12 x 16	mm	

	M1			
	M0			
	Modification	Date	Visa émetteur	

Condensateurs CH 1401 Yverdon-les-Bains
 Kondensatoren Tel.: ++41 24 445 66 88
 Capacitors Fax: ++41 24 445 66 89

Le lanché
Capacitors
A FISCHER & TAUSSIG COMPANY

HJJ

08.02.2006

faisab5540.XLS