

#5898

Metallized polypropylene capacitors

PPM 380-2.0 r K

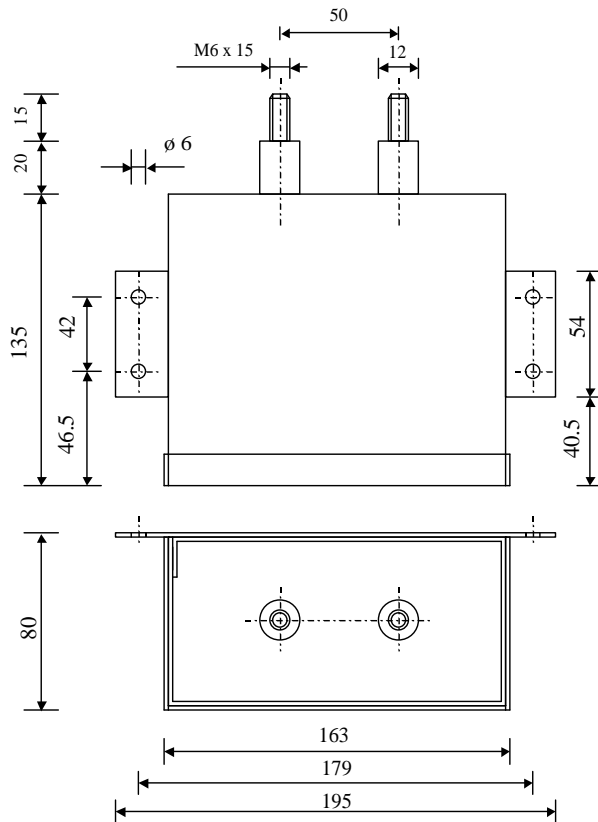

Dielectric of metallized polypropylene

Construction entirely dry components

Threaded outputs

Resin end sealing

Aluminium case thick 1.2 mm

Grounding direct in case

| Parameter                              | Symbol       | Value          | Unit               | Condition       |
|--|--------------|----------------|--------------------|-----------------|
| Capacitance                            | C            | 2              | $\mu\text{F}$      | 1 V / 1 kHz     |
| Tolerance                              |              | $\pm 10$       | %                  |                 |
| Rated voltage                          | Un DC        | 3'800          | VDC                |                 |
| Rated voltage                          | Un AC        | 1300           | Veff               | 50 Hz           |
| Maximum Voltage                        | U max        | 2800           | Veff               | 50 Hz           |
| RMS Current                            | Ieff         | 15             | Aeff               | 10 kHz          |
| slope of voltage variation             | du/dt max.   | 200            | V/ $\mu\text{sec}$ | max. repetitive |
| Repetitive surge current               | I cr. max    | 400            | A                  |                 |
| Tangent delta                          | tg $\delta$  | 8              | $10^{-4}$          | 1 V / 1 kHz     |
| Stray inductance                       | ESL          | $\leq 450$     | nH                 |                 |
| Insulation resistance                  | Ri x C       | $> 20'000$     | s                  | 500 VDC - 1 min |
| Test voltage between terminals         | U T1         | 6'000          | VDC                | 1 min           |
| Test voltage between terminals to case | U T2         | 6'000          | VDC                | 1 min           |
| Operating temp.                        |              | - 25 / + 70 °C |                    |                 |
|  |              |                |                    |                 |
|  |              |                |                    |                 |
| Dimension                              | Symbol       |                | Unit               | Conditions      |
| Width                                  | B            | 80             | mm                 |                 |
| Length                                 | L            | 163            | mm                 |                 |
| Height                                 | H            | 135            | mm                 |                 |
| Thread                                 |              | M6 x 15        | mm                 |                 |
| Thread spacing                         |              | 50             | mm                 |                 |
|  |              |                |                    |                 |
|  | M1           |                |                    |                 |
|  | M0           |                |                    |                 |
|  | Modification | Date           | Visa émetteur      |                 |

Condensateurs CH 1400 Yverdon-les-Bains  
 Kondensatoren Tel.: ++41 24 445 66 88  
 Capacitors Fax: ++41 24 445 66 89

**Le Lanché**  
**Capacitors**  
A FISCHER & TAUSSCHER COMPANY

HJJ

15.02.2010

faisab5898.XLS