

#5595

Filtering Capacitors

PPM 300-10.0 ru K

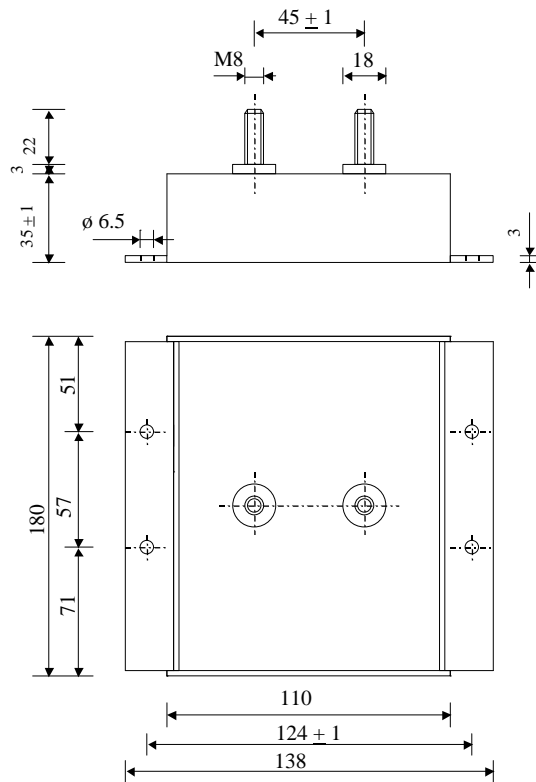

Dielectric of metallized polypropylene

Threaded outputs

Resin end sealing

Plastic case
thick 3.0 mm

Parameter	Symbol		Value	Unit	Condition
Capacitance	C		10	μF	1 V / 1 kHz
Tolerance			± 10	%	
Rated voltage	Un DC		3'000	VDC	
RMS Current 10 kHz to 100 kHz	I _{eff} max		70	A _{eff}	Temp.amb. 25°C
RMS Current 10 kHz to 100 kHz	I _{eff} max		57	A _{eff}	Temp.amb. 45°C
RMS Current 10 kHz to 100 kHz	I _{eff} max		41	A _{eff}	Temp.amb. 65°C
RMS Current 10 kHz to 100 kHz	I _{eff} max		30	A _{eff}	Temp.amb. 75°C
Repetitive surge current	I cr. max		2800	A	
Tangente delta	tgδ		< 20	10 ⁻⁴	1 V / 10 kHz
Equivalent serie resistance	ESR		≤ 3.5	mΩ	100 kHz
Stray inductance	ESL		≤ 25	nH	
Insulation resistance	Ri x C		> 20'000	s	500 VDC - 1 min
Test voltage between terminals	U T1		4'500	VDC	10 s
Test voltage between terminals to case	U T2		4'000	VAC	10 s
Climatic category (IEC 60068)			40/85/56		
Estimated operational life (-3%)			100'000	h	Un DC / 70°C

Dimension	Symbol		Value	Unit	Condition
Width	B		110	mm	
Length	L		180	mm	
Height	H		35	mm	
Thread			M 8 x 22	mm	
Thread spacing			45	mm	

	M1				
	M0				
	Modification	Date	Visa émetteur		

Condensateurs CH 1401 Yverdon-les-Bains
 Kondensatoren Tel.: ++41 24 445 66 88
 Capacitors Fax: ++41 24 445 66 89

Le Lanché
Capacitors
A FISCHER & TALECHÉ COMPANY

HJJ

28.09.2006

faisab5595.XLS