

#5911

METALLIZED POLYPROPYLENE CAPACITORS

PPM 1500-110 ru K

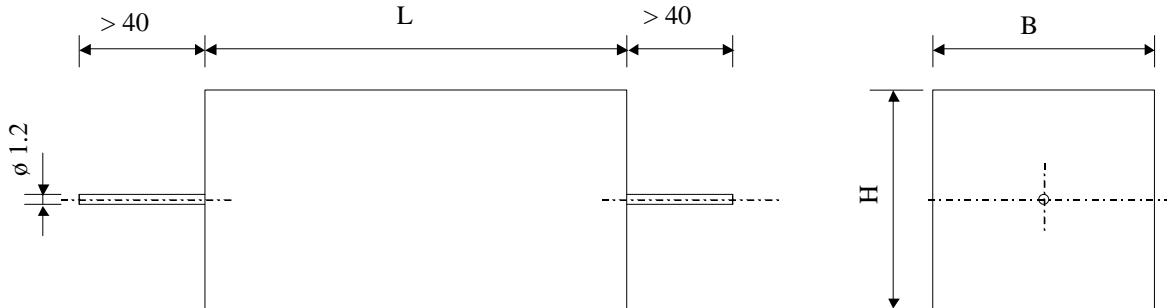

Dielectric of metallized polypropylene

Plastic case - resin filled

Parameter	Symbol		Value	Unit	Condition
Capacitance	C		0.01	$\mu\text{F}$	1 V / 1 kHz
Tolerance			$\pm 10$	%	
Rated voltage	Un DC		15'000	VDC	
Rated voltage	Un AC		7200	VAC	50 Hz
slope of voltage variation	du/dt max.		5'000	V/ $\mu\text{sec}$	max. repetitive
Repetitive surge current	I cr. max		50	A	
Tangente delta	tg $\delta$		6	$10^{-4}$	1 V / 1 kHz
Tangente delta	tg $\delta$		12	$10^{-4}$	1 V / 10 kHz
Stray inductance	ESL		$\leq 160$	nH	
Insulation resistance	Ri		$> 100'000$	M $\Omega$	300 VDC - 1 min
Test voltage between terminals	U T1		22'500	VDC	10 s.
Climatic category			40/85/56		
Estimated operational life (-3%)			100'000	h	Un DC / 70°C
Dimension	Symbol			Unit	Conditions
Width	B		$42 \pm 1$	mm	
Height	H		$40 \pm 1$	mm	
Length	L		$100 + 0 / -1$	mm	
Terminals					
Axial tinned wire	d		$\varnothing 1.2 \times 40$	mm	
	M1				
	M0				
	Modification	Date	Visa émetteur		

Condensateurs CH 1400 Yverdon-les-Bains  
 Kondensatoren Tel.: ++41 24 445 66 88  
 Capacitors Fax: ++41 24 445 66 89

**Le lanché**  
**Capacitors**  
A FISCHER & TAUSSIG COMPANY

HJJ

23.03.2010

faisab5911.XLS