

#5699

METALLIZED POLYPROPYLENE CAPACITORS

PPM 120-3.3 cs1 K

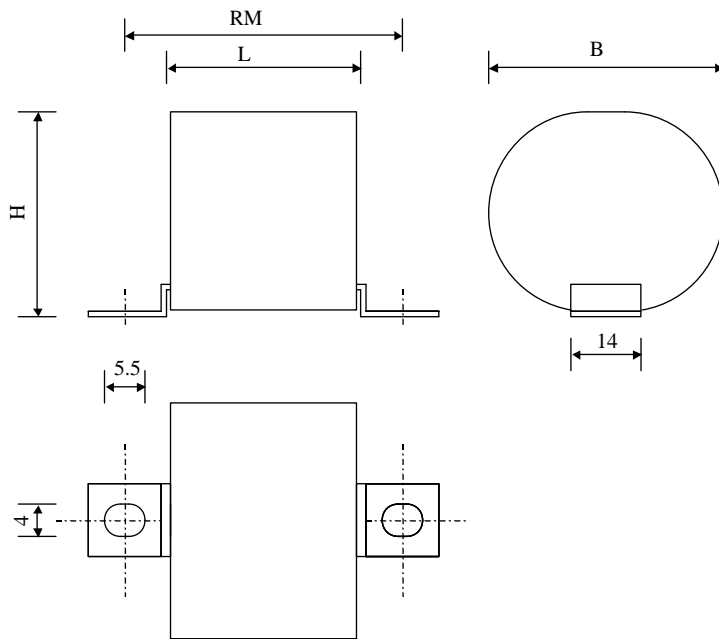

20 kHz to 100 kHz Temp. [°C]	I RMS max. [A]
25	47
50	39
85	24
105	5.7

Dielectric of metallized polypropylene
Polyester wrapped / Epoxy resin sealing

Parameter	Symbol		Value	Unit	Condition
Capacitance	C		3.3	μF	1 V / 1 kHz
Tolerance			± 10	%	
Rated voltage	Un DC		1200	VDC	
Rated voltage	Un AC		460	VAC	50 Hz
slope of voltage variation	du/dt max.		220.0	V/μsec	max. repetitive
Repetitive surge current	I cr. max		726	A	
Tangent delta	tgδ		4	10 ⁻⁴	1 V / 1 kHz
Equivalent serie resistance	ESR		≤ 5.0	mΩ	100 kHz
Stray inductance	ESL		≤ 50	nH	
Insulation resistance	Ri x C		50'000	s	500 VDC - 1 min
Test voltage between terminals	U T1		1800	VDC	1 min
Operating temperature range			-40 / + 105 °C		
Estimated operational life (-3%)			200000	h	Un DC / 70°C
Dimension	Symbol			Unit	Conditions
Width	B max		46	mm	
Height	H max		37	mm	
Length	L		63.5± 1.5	mm	
Terminals					
Tinned copper			14 x 0.8	mm	
	RM		83.4 ± 1.5		
	M1				
	M0				
	Modification	Date	Visa émetteur		

Condensateurs CH 1400 Yverdon-les-Bains
Kondensatoren Tel.: ++41 24 445 66 88
Capacitors Fax: ++41 24 445 66 89

Le Janché
Capacitors
A FISCHER & TAUSSCH COMPANY

HJJ

04.12.2007

faisab5699.XLS