

#5953

METALLIZED POLYPROPYLENE CAPACITORS

PPM 100-260.0 cv5 K

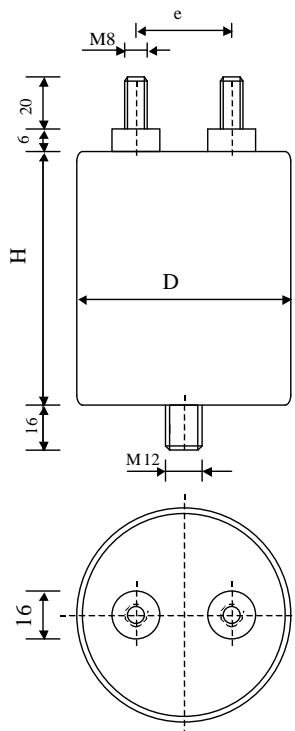

Dielectric of metallized polypropylene

Threaded outputs

Resin end sealing

Aluminium case

Parameter	Symbol	Value	Unit	Condition
Capacitance	C	260	μF	1 V / 1 kHz
Tolerance		± 10	%	
Rated voltage	Un DC	1000	VDC	
Maximum Voltage 1 s.	Um	1200	V	every 10 min
RMS Current permanent	I _{eff max.}	32	A _{eff}	12 kHz
Repetitive surge current	I _{cr. max}	1400	A	
Tangent delta	tg δ	≤ 65	10^{-4}	1 V / 1 kHz
Equivalent serie resistance	ESR	25°C to 70°C	3.6	m Ω 1 V / 10 kHz
Stray inductance	ESL	≤ 55	nH	
Insulation resistance	Ri x C	$\geq 30'000$	s	500 VDC - 1 min
Test voltage between terminals	U T1	1500	VDC	10 s
Test voltage terminals to case	U T2	3500	VAC	50 Hz / 1 min
Climatic category		40/70/56		
Estimated operational life (-7 %)		> 100'000	h	Un DC / 65°C
Dimension	Symbol	Value	Unit	Conditions
Diameter	D	85	mm	
Height	H max	101	mm	
Terminals				
Thread		M8 x 20	mm	
Thread spacing	e	32 \pm 0.5	mm	
Fixing stud		M12 x 16	mm	
Mass approx.	m		kg	
	M1			
	M0			
	Modification	Date	Visa émetteur	

Condensateurs CH 1400 Yverdon, Switzerland
 Kondensatoren Tel.: ++41 24 447 22 82
 Capacitors Fax: ++41 24 447 22 85

Leclanché
Capacitors
A FISCHER & TILLSCHKE COMPANY

HJJ

www.Lcap.ch
 23.08.2010

capinfo@Lcap.ch
 faisab5953.XLS