

#5914

METALLIZED POLYPROPYLENE CAPACITORS

PPM 100-150.0 cv5 K

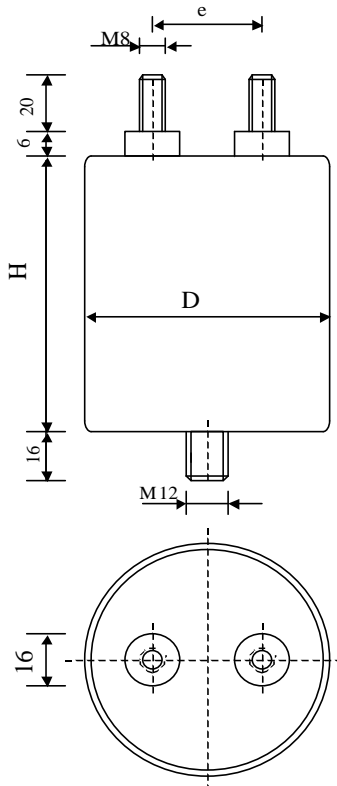

Dielectric of metallized polypropylene

Threaded outputs

Resin end sealing

Aluminium case

Parameter	Symbol		Value	Unit	Condition
Capacitance	C		150	μF	1 V / 1 kHz
Tolerance			± 10	%	
Rated voltage	Un DC		1000	VDC	
Maximum Voltage 2 s.	Um		1550	V	every 20 min
Overvoltage 2 s.	U ϵ		1300	V	every 5 min
RMS Current permanent	I _{eff max.}		33	A _{eff}	
Repetitive surge current	I cr. max		1400	A	
Tangent delta	tg δ		≤ 50	10^{-4}	1 V / 1 kHz
Equivalent serie resistance	ESR	25°C to 70°C	5,5	m Ω	1 V / 10 kHz
Stray inductance	ESL		≤ 55	nH	
Insulation resistance	Ri x C		$\geq 30'000$	s	500 VDC - 1 min
Test voltage between terminals	U T1		2000	VDC	10 s
Test voltage terminals to case	U T2		3500	VAC	50 Hz / 1 min
Climatic category			40/70/56		
Estimated operational life (-7 %)			> 200'000	h	Un DC / 70°C

Dimension	Symbol		Unit	Conditions
Diameter	D		85	mm
Height	H		101	mm
Terminals				
Thread			M8 x 20	mm
Thread spacing	e		32	mm
Fixing stud			M12 x 16	mm
Mass approx.	m			kg
	M1			
	M0	13.04.2010	FS	H porté à 101mm
	Modification	Date	Visa émetteur	

Condensateurs CH 1400 Yverdon-les-Bains
 Kondensatoren Tel.: ++41 24 447 22 82
 Capacitors Fax: ++41 24 447 22 85

Le lanché
Capacitors
A FISCHER & PAUSCHKE COMPANY

HJJ

HJJ

07.04.2010

faisab5914.XLS