

#5871

METALLIZED POLYPROPYLENE CAPACITORS

PAM 45-50.0 c2d K

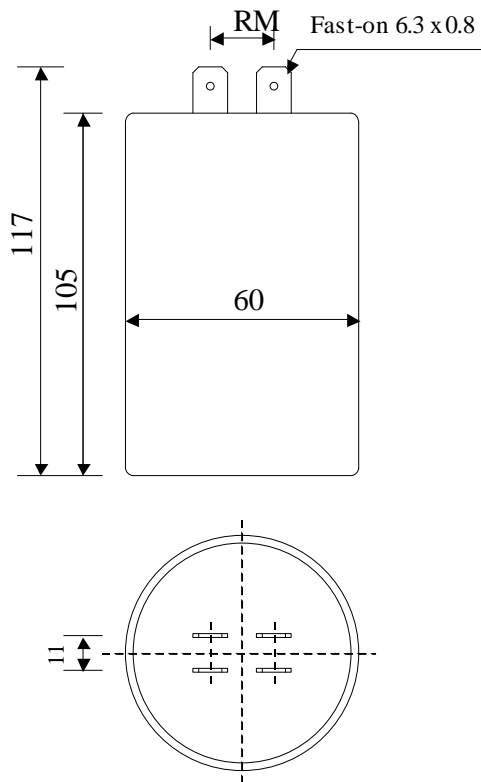

Dielectric of metallized polypropylene

FAST-ON 6.3 x 0.8 mm

Epoxy resin end sealing

Aluminium case

Parameter	Symbol	Value	Unit	Condition
Capacitance	C	50	$\mu\text{F}$	1 V / 1 kHz
Tolerance		$\pm 10$	%	
Rated voltage	Un AC	450 / 500	VAC	50 / 60 Hz
RMS Current	I <sub>eff</sub> max.	20	A <sub>eff</sub>	10 kHz
slope of voltage variation	du/dt max.	20	V/ $\mu\text{sec}$	max. repetitive
Repetitive surge current	I cr. max	1000	A	
Tangent delta	tg $\delta$	$\leq 30$	$10^{-4}$	1 V / 1 kHz
Equivalent serie resistance	ESR	9	m $\Omega$	1 V / 10 kHz
Stray inductance	ESL	$\leq 100$	nH	
Insulation resistance	Ri	$> 200$	M $\Omega$	500 VDC - 1 min
Test voltage between terminals	U T1	1950	VDC	10 s
Test voltage terminals to case	U T2	2000	VAC	50 Hz / 1 min
Operating temperature		-25 / + 85 °C		
Dimension	Symbol	Value	Unit	Conditions
Diameter	D	60	mm	
Height	H	105	mm	
Terminals				
Fast-on	4 x	6.3 x 0.8	mm	
Raster mass	RM	14 $\pm$ 1	mm	
	M1			
	M0			
	Modification	Date	Visa émetteur	

Condensateurs CH 1400 Yverdon-les-Bains  
 Kondensatoren Tel.: ++41 24 445 66 88  
 Capacitors Fax: ++41 24 445 66 89

**Le Janché**  
**Capacitors**  
A FISCHER & TAUSSIG COMPANY

HJJ

04.11.2009

faisab5871.XLS