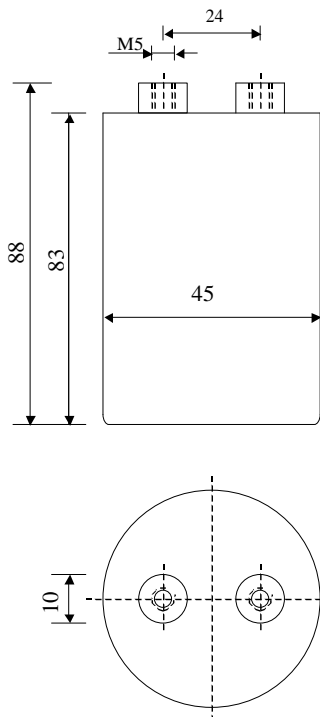

2988

Capacitor for power electronics

TYPE
PAM 25-20.0 c6Dielectric of metallized
polypropylene

Threaded outputs

Epoxy resin end sealing

Aluminium case

Paramètre	Symbol	Value	Unit	Condition
Capacitance	C	20	μF	20°C, 1 kHz
Tolérance		± 10	%	
Rated voltage	Un AC	250	VAC	50 Hz
Rated voltage	Un DC	400	VDC	
RMS current max	I eff	25	A eff	f > 2 to 100 kHz
slope of voltage variation	du/dt max.	30	V/ μs	max. repetitive
Max repetitive peak current	I cr. max	600	A	
Tangent of the loss angle	tg δ	$\leq 7 \text{ E-}4$		1 V / 1 kHz / 25 °C
Equivalent serie resistance	ESR	≤ 3.4	m Ω	1 V - 10 kHz
Stray inductance	ESL	≤ 150	nH	
Insulation resistance	Ri x C	> 20'000	s	500 VDC - 1 min
Test voltage between terminals	U T1	640	VDC	10 s.
Test voltage terminals to case	U T2	2500	VAC	50 Hz - 1 min
Climatic category		40/85/56		
Estimated operational life (-3%)		50'000	h	Un AC / 70°C

Dimension	Symbole	Value	Unité	Conditions
Diameter	$\varnothing D$	45	mm	
Height	H	83	mm	
Terminals				
Thread		M5 x 10	mm	
Thread spacing		24	mm	

Valeurs indicatives, sous réserve de modification	M2			
	M1			
	M0			
	Modification	Date	Visa émetteur	

Condensateurs CH 1401 Yverdon-les-Bains
 Kondensatoren Tel.: ++41 24 445 66 88
 Capacitors Fax: ++41 24 445 66 89

Le lanché
Capacitors
A FISCHER & TAUERCHER COMPANY

HJJ

11.05.2005

PAM2988.XLS