

#5855

Discharge Capacitors

MKTF 60-5000.0 r K

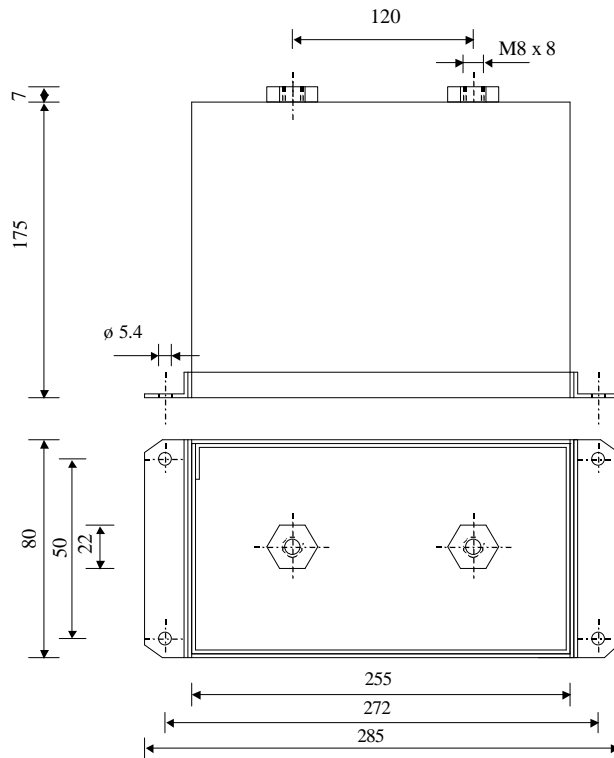

Dielectric of metallized polyester

Threaded outputs

Resin end sealing

Aluminium case
thick 1.2 mm

Parameter	Symbol	Value	Unit	Condition
Capacitance	C	5000	μF	1 V / 100 Hz
Tolerance		± 10	%	
Rated voltage	$U_n \text{ DC}$	600	VDC	
Surge current	I cr. max	1'000	A	
Equivalent serie resistance	ESR	≤ 2.6	$\text{m}\Omega$	1 kHz
Stray inductance	ESL	≤ 50	nH	
Insulation resistance	$R_i \times C$	$> 10'000$	s	100 VDC - 1 min
Test voltage between terminals	U T1	660	VDC	10 s
Test voltage between terminals to case	U T2	2'500	VAC	50 Hz - 1 min
Operating temp.		- 25 / + 70 °C		
Dimension	Symbol		Unit	Conditions
Width	B	80	mm	
Length	L	255	mm	
Height	H	175	mm	
Thread		M8 x 8	mm	
Thread spacing		120	mm	
	M1			
	M0			
	Modification	Date	Visa émetteur	

Condensateurs CH 1400 Yverdon-les-Bains
 Kondensatoren Tel.: ++41 24 445 66 88
 Capacitors Fax: ++41 24 445 66 89

Le lanché
Capacitors
A FROBEN & TALECHÉ COMPANY

HJJ

18.09.2009

faisab5855.XLS