

#5858

Power Electronics Capacitors

MKS 4-010 SMD K

PRELIMINARY

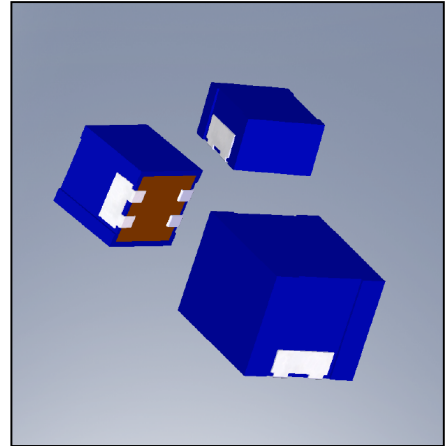
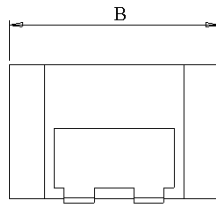
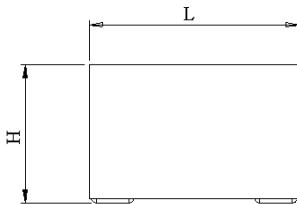
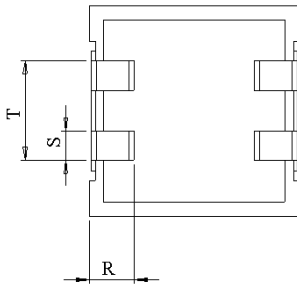

Surface mount device - Self-extinguishing plastic housing
 Dielectric metallized polyphenylene sulfide - Epoxy resin sealing UL 94-V0

| Parameter | Symbol | | Value | Unit | Condition |
|--------------------------------|-------------|--|------------|--------------------|----------------|
| Capacitance | C | | 0.1 | μF | 1 V / 1 kHz |
| Tolerance | | | ± 10 | % | |
| Rated voltage | Un DC | | 40 | VDC | |
| RMS current | I RMS max. | | | Aeff | |
| slope of voltage variation | du/dt max. | | | V/ μsec | |
| Repetitive surge courant | I cr. max | | | A | |
| Tangent delta | tg δ | | ≤ 20 | 10^{-4} | 1 kHz / 23°C |
| Equivalent serie resistance | ESR | | | m Ω | |
| Stray inductance | ESL | | | nH | |
| Insulation resistance | Ri | | $> 30'000$ | M Ω | 10 VDC - 1 min |
| Test voltage between terminals | U T1 | | 64 | VDC | 10 s |
| Climatic category | | | 55/125/56 | | |

| Dimension | Symbol | | Value | Unit | Conditions |
|-----------|--------------|------|-----------------|------|------------|
| Width | B max | | 7.5 | mm | |
| Height | H max | | 4.5 | mm | |
| Length | L max | | 8 | mm | |
| Terminals | | | | | |
| | R | | 2.25 ± 0.25 | mm | |
| | S | | 1.0 ± 0.2 | mm | |
| | T | | 4.0 ± 0.2 | mm | |
| | M1 | | | | |
| | M0 | | | | |
| | Modification | Date | Visa émetteur | | |

Condensateurs CH 1400 Yverdon-les-Bains
 Kondensatoren Tel.: ++41 24 445 66 88
 Capacitors Fax: ++41 24 445 66 89

Le lanché
Capacitors
A FISCHER & TAUSSCHÉ COMPANY

HJJ

24.09.2009

faisab5858.XLS