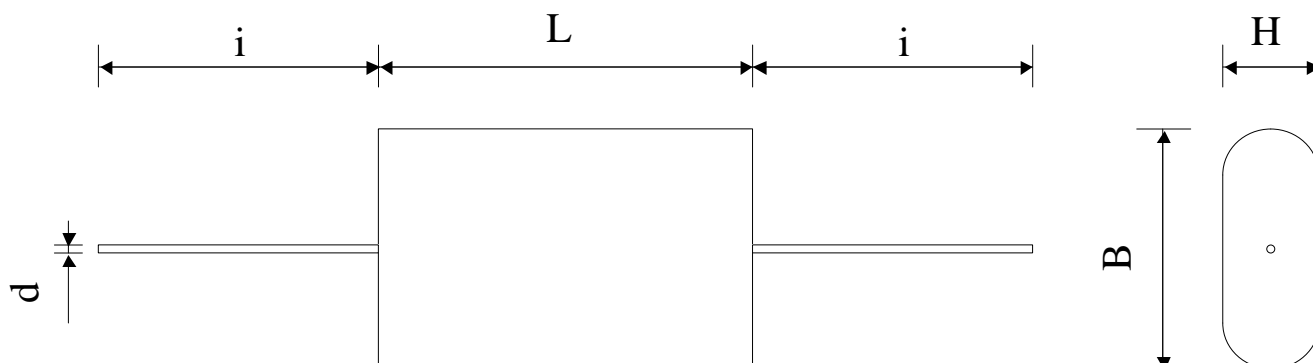

5693

**METALLIZED POLYPROPYLENE
+ FILM-FOIL CAPACITORS**
**TYPE
KPS 85-2.0 df (K)**

Dielectric: Polypropylene metallized + film-foil

Plastic sleeve / Epoxy resin sealing

| Paramètre | Symbol | Value | Unit | Condition |
|-----------------------------------|-----------------------|----------------|------------------|-----------------|
| Capacitance | C | 2 | μF | 20°C, 1 kHz |
| Tolérance | | 10 | % | |
| Rated voltage | Un DC | 850 | VDC | 85 °C max. |
| Rated voltage | Un AC | 360 | VAC | 50 / 60 Hz |
| RMS Current | I _{eff} max. | 22.4 | A _{eff} | 100 kHz / 70 °C |
| Slope of voltage variation | du/dt max. | 580 | V/ μs | max. repetitive |
| Repetitive surge current | I cr. max | 1160 | A | max. repetitive |
| Tangent delta dielectric | tg δ_o | 2 E-4 | | |
| Serial resistance | R _s | 3.3 | m Ω | |
| Stray inductance | ESL | ≤ 40 | nH | |
| Insulation resistance | R _i | > 50'000 | M Ω | 100 VDC - 1 min |
| Test voltage between terminals | U T1 | 1'700 | VDC | 60 s. |
| Operating Range | | -55 / + 105 °C | | |
| Estimated operational life (-3 %) | | 100'000 | h | Un / 70°C |

| Dimension | Symbole | Value | Unité | Conditions |
|-------------------|---------|-------------------|-------|------------|
| Width | B max | 36.2 | mm | |
| Height | H max | 24.7 | mm | |
| Length | L max | 64 | mm | |
| Terminals | | | | |
| Axial tinned wire | d | $\varnothing 1.2$ | mm | |
| Length | i | ≥ 40 | mm | |

| | | | | |
|--|--------------|------|---------------|--|
| | M2 | | | |
| | M1 | | | |
| | MC | | | |
| | Modification | Date | Visa émetteur | |

 Condensateurs CH 1400 Yverdon-les-Bains
 Kondensatoren Tel.: ++41 24 445 66 88
 Capacitors Fax: ++41 24 445 66 89

Le lanché
Capacitors
A FISCHER & TAUSSCHE COMPANY

HJJ

16.10.2007

faisab5693.XLS