

# 5574	METALLIZED POLYPROPYLENE + FILM-FOIL CAPACITORS	TYPE KPS 160-015 cs2 K
--------	--	---------------------------

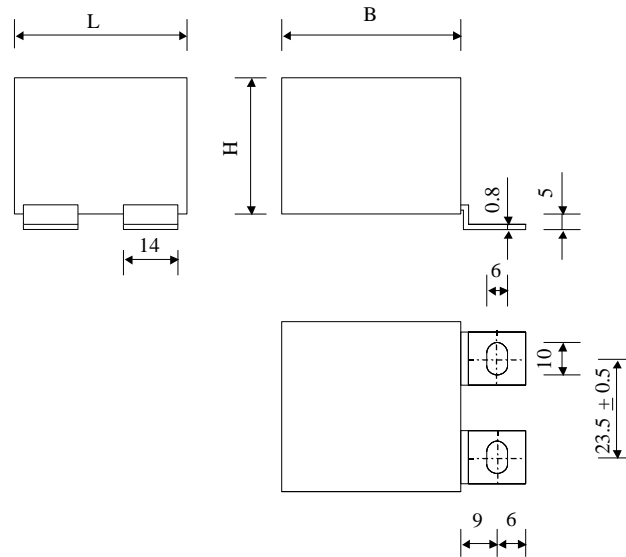

Dielectric: Polypropylene metallized + film-foil

Self-extinguishing plastic housing / Epoxy resin sealing

Paramètre	Symbol	Value	Unit	Condition
Capacitance	C	150	nF	20°C, 1 kHz
Tolérance		10	%	
Rated voltage	Un DC	1'600	VDC	
Rated voltage	Un AC	500	VAC	50 Hz to 18 kHz
RMS Current	I _{eff} max.	8.5	A _{eff}	18 kHz to 100 kHz
Slope of voltage variation	du/dt max.	3'200	V/μs	max. repetitive
Repetitive surge current	I _{cr} max	480	A	max. repetitive
Tangent delta	tgδ	≤ 4.0 E-4		1 V / 10 kHz / 20 °C
Stray inductance	ESL	≤ 20	nH	
Insulation resistance	Ri	> 100'000	MΩ	100 VDC - 1 min
Test voltage between terminals	U T1	2'600	VDC	10 s.
Climatic category		55/85/56		
Estimated operational life (-3 %)		100'000	h	Un / 70°C

Dimension	Symbole	Value	Unité	Conditions
Width	B	34	mm	
Height	H	20	mm	
Length	L	42	mm	
Terminals				
Tinned copper	RM	23.5	mm	

Tentatives Values only, subject to technical modification	M2			
	M1			
	M0			
	Modification	Date	Visa émetteur	