

Leclanché Capacitors
48, av. de Grandson
1400 Yverdon, Switzerland



Tel. +41 24 445 66 88
Fax +41 24 445 66 89
capinfo@Lcap.ch
www.Lcap.ch

Drawing No. : 100011521
created from : 30/10/2013 15:35:00

Part Number : GW33216050100

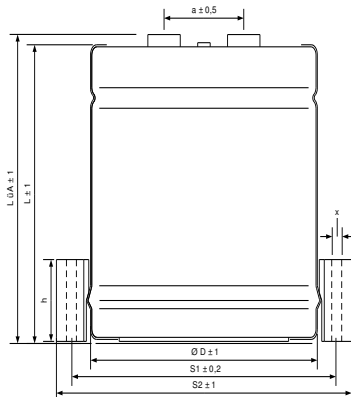

Ø D : 50 mm
L / L üA : 100 / 105 mm
x : 4,5 mm
a : 22 mm
S1 / S2 : 63 / 75,5
Terminals : M5

mm
mm

Electrical Parameter

Rated Capacitance (C _R) @ 100 Hz / 20 °C	3300 µF	
Tolerance	±20 %	
Rated Voltage (U _R)	160 V	
Surge Voltage (U _S) max. 5 x 1 min / h	184 V	
Reverse Voltage (U _U) max. 1 s	2 V	
Leakage Current (I _L) @ U _R / 5 min / 20 °C	3168 µA	
ESR typ. @ 100 Hz / 20°C	34 mΩ	
Tan δ typ. @ 100 Hz / 20°C	7 %	
Z max. @ 10 kHz / 20°C	27 mΩ	
ESL typ.	20 nH	
Rated Ripple Current (I _R) @ 100 Hz / 105 °C	6 A	20 A@85°C and 7kHz
Useful life @ I _R , U _R , 105 °C	8000 h	32kh@65°C and 20 A/7kHz 128kh@65°C and 7,6A@7kHz
IEC Climatic category / Standards	40/105/56	IEC 60384-4
Applications	industrial	
Your article No. / Project		