

Leclanché Capacitors
48, av. de Grandson
1400 Yverdon, Switzerland

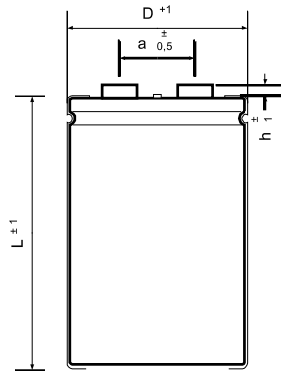

Tel. +41 24 445 66 88
Fax +41 24 445 66 89
capinfo@Lcap.ch
www.Lcap.ch

Part Number : EFHTF 250-330 35082



∅ D : 35 mm
L : 80 mm
a : 13 mm
h : 6 mm

Terminals : M 5

These capacitors are to be delivered in pairs, compliant with Thomson-Sintra specifications, reference number 96184829

Electrical Parameter

Rated Capacitance (C_R) @ 100 Hz / 20 °C	330 μ F	
Tolerance	-10 +30 %	
Rated Voltage (U_R)	250 V	
Surge Voltage (U_S) max. 5 x 1 min / h	288 V	
Reverse Voltage (U_U) max. 1 s	2 V	
Leakage Current (I_L) @ U_R / 5 min / 20 °C	494 μ A	
ESR typ. @ 100 Hz / 20°C	193 m Ω	
Tan δ typ. @ 100 Hz / 20°C	4 %	
Z max. @ 10 kHz / 20°C	189 m Ω	
ESL typ.	20 nH	
Rated Ripple Current (I_R) @ 100 Hz / 105 °C	1.5 A	
Useful life @ I_R , U_R , 105 °C	2000 h	
IEC Climatic category / Standards	55/125/56	IEC 60384-4
Applications		
Your article No. / Project		

Leclanché Capacitors
48, av. de Grandson
1400 Yverdon, Switzerland



Tel. +41 24 445 66 88
Fax +41 24 445 66 89
capinfo@Lcap.ch
www.Lcap.ch

Part Number : EFHTF 250-330 35082

	$\varnothing D :$ 35 mm	
	L : 80 mm	
	a : 13 mm	
	h : 7 mm	
	Terminals : M 5	

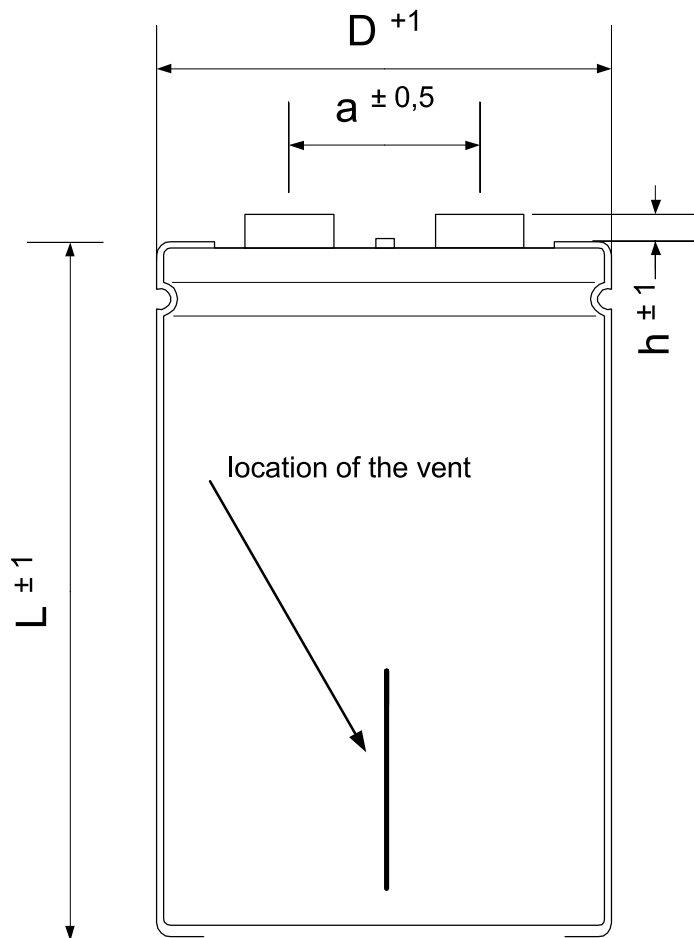

The capacitors are provided with pressure safety vents located in the lower end of the can.