

Leclanché Capacitors  
48, av. de Grandson  
1400 Yverdon, Switzerland



Tel. +41 24 445 66 88  
Fax +41 24 445 66 89  
[capinfo@Lcap.ch](mailto:capinfo@Lcap.ch)  
[www.Lcap.ch](http://www.Lcap.ch)

Drawing No. : 1011359-53567

created: hs 17/01/2014 10:27:00

**Typ : EFA 350-3300 75145**

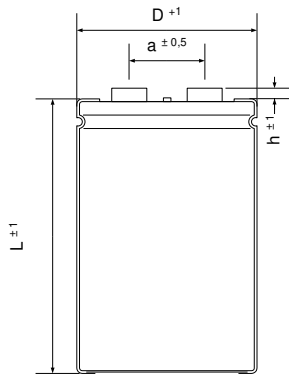

∅ D : 75 mm  
L : 145 mm  
a : 31,7 mm  
h : 5 mm

Terminals : M5

Printing:  
>LECLANCHE Logo<  
EFA  
350-3300 75145  
3300 µF -10+30%  
350VDC  
>Date Code<

**Electrical Parameters**

Rated Capacitance ( $C_R$ ) @ 100 Hz / 20 °C	<b>3300</b> µF	
Tolerance	<b>-10 +30</b> %	
Rated Voltage ( $U_R$ )	<b>350</b> V	
Surge Voltage ( $U_S$ ) max. 5 x 1 min / h	<b>385</b> V	
Reverse Voltage ( $U_U$ ) max. 1 s	<b>2</b> V	
Leakage Current ( $I_L$ ) @ $U_R$ / 5 min / 20 °C	<b>6930</b> µA	
ESR typ. @ 100 Hz / 20°C	<b>39</b> mΩ	
Tan δ typ. @ 100 Hz / 20°C	<b>8</b> %	
Z max. @ 10 kHz / 20°C	<b>31</b> mΩ	
ESL typ.	<b>20</b> nH	
Rated Ripple Current ( $I_R$ ) @ 100 Hz / OKT °C	<b>7,5</b> A	30A @ 50°C / 200 Hz
Useful life @ $I_R, U_R, OKT$ °C	<b>8000</b> h	
IEC Climatic category / Standards	<b>40/105/56</b>	<b>IEC 60384-4</b>
Applications	General Industrial	
Your article No.. / Project		