

#6275

Discharge capacitors

PPMF 100-4.0 d K

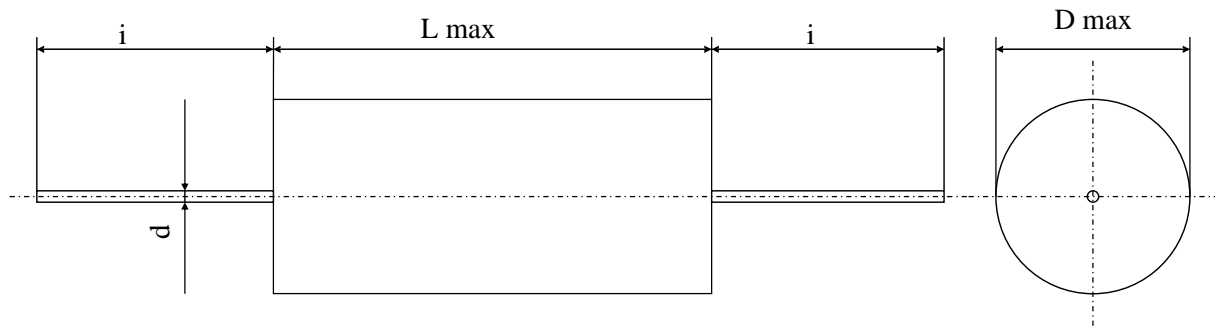

Dielectric of metallized polypropylene

Plastic sleeve / Epoxy resin sealing

Parameter	Symbol	Value	Unit	Condition
Capacitance	C	4	μF	1 V / 1 kHz
Tolerance		± 10	%	
Rated voltage	U_n	1000	V	
slope of voltage variation	$du/dt \text{ max.}$	37.5	V/ μsec	max. repetitive
Peak current rep.	$I_{cr. \text{ Max.}}$	150	A	
Maximum current	I_{eff}	2.5	A RMS	10 kHz
Tangent delta	$tg\delta$	< 25	10^{-4}	1 V / 1 kHz
Stray inductance	ESL	≤ 25	nH	
Insulation resistance	$R_i \times C$	20'000	s	500 VDC - 1 min
Test voltage between terminals	U_{T1}	2200	VDC	10 s
Estimated operational life (-3%)		> 100000	h	1500 V - 70°C
Estimated operational life 30°C		$> 1E6$	Pulses	1000 V p-p 150 A

Dimension	Symbol	Value	Unit	Conditions
Diameter	D max.	19	mm	
Height	L max.	87	mm	
Terminals				
Thread	d	0.8	mm	
	i	≥ 30	mm	
	M1			
	M0			
	Modification	Date	Visa émetteur	

Condensateurs CH 1400 Yverdon, Switzerland
 Kondensatoren Tel.: ++41 24 445 66 88
 Capacitors Fax: ++41 24 445 66 89

Leclanché
Capacitors
A FISCHER & TAUSSIG COMPANY

HJJ

www.Lcap.ch
 13.03.2014

capinfo@Lcap.ch
 faisab6275.XLS