

#5660

Power Electronics Capacitors

PPM-4 45-6.8 a K

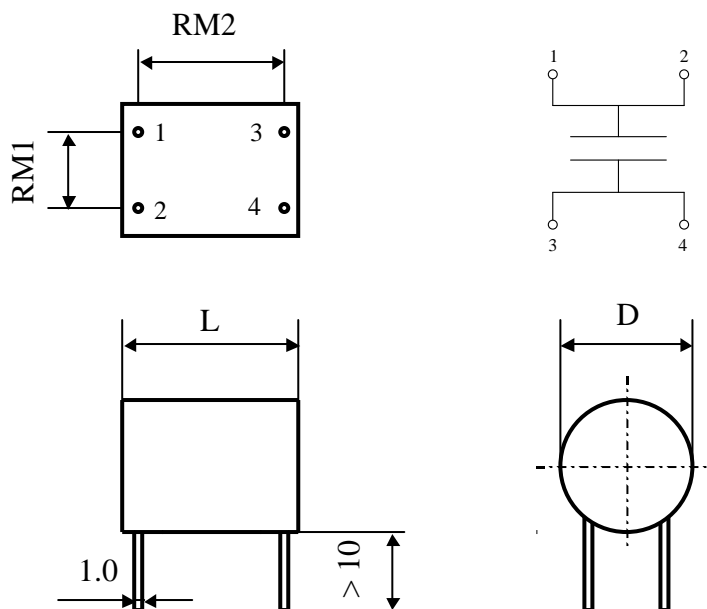

Dielectric : metallized polypropylene
Polyester wrapped

Epoxy resin sealing

Parameter	Symbol		Value	Unit	Condition
Capacitance	C		6.8	μF	1 V / 1 kHz
Tolerance			± 10	%	
Rated voltage	Un DC		450	VDC	
Rated voltage	Un AC		100	Veff	50Hz to 1 kHz
RMS current	I RMS max.		9	Aeff	200 kHz
Tangente delta	$\text{tg}\delta$		≤ 5	10^{-4}	1 kHz
Equivalent serie resistance	ESR		≤ 6.0	$\text{m}\Omega$	10 kHz
Stray inductance	ESL		≤ 15	nH	
Insulation resistance	Ri		> 1400	$\text{M}\Omega$	300 VDC - 1 min
Test voltage between terminals	U T1		600	VDC	10 s
Climatic category			40/105/56		
Estimated operational life (-3%)			100000	h	450 V - 70°C
Dimension	Symbol			Unit	Conditions
Diameter	D		20	mm	
Length	L		33	mm	
Terminals					
Radial tinned wire	\emptyset		1	mm	
RM1			10	mm	
RM2			29	mm	
	M1				
	M0				
	Modification	Date	Visa émetteur		

Condensateurs

CH 1401 Yverdon-les-Bains

Kondensatoren

Tel.: ++41 24 445 66 88

Capacitors

Fax: ++41 24 445 66 89

Le lanché
Capacitors
A FISCHER & HANSCHE COMPANY

HJJ

21.04.2006

faisab5660.XLS