

#5686

METALLIZED POLYPROPYLENE CAPACITORS

PPM 800-125 df K

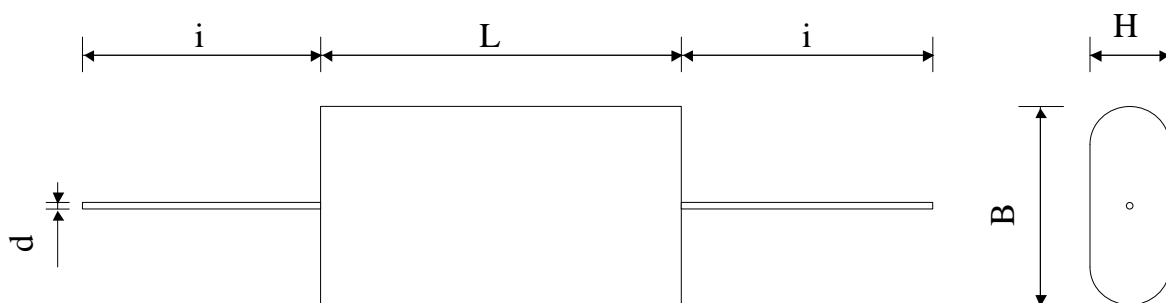

Dielectric of metallized polypropylene

Polyester wrapped

Epoxy resin sealing

Parameter	Symbol		Value	Unit	Condition
Capacitance	C		0.025	μF	1 V / 1 kHz
Tolerance			± 10	%	
Rated voltage	Un DC		8000	VDC	
Rated voltage	Un AC		1000	Veff	50 Hz
RMS Current Max.	I <sub>eff</sub>		1.6	A <sub>eff</sub>	10 kHz
slope of voltage variation	du/dt max.		2'000	V/μsec	max. repetitive
Repetitive surge current	I cr. max		50	A	
Tangent delta	tgδ		4	10 <sup>-4</sup>	1 V / 1 kHz
Tangent delta	tgδ		4	10 <sup>-4</sup>	1 V / 10 kHz
Stray inductance	ESL		≤ 40	nH	
Insulation resistance	Ri		> 50'000	MΩ	100 VDC - 1 min
Test voltage between terminals	U T1		12800	VDC	10 s
Operating temp.			- 40 / + 85 °C		
Estimated operational life (-3%)			100000	h	8000 V - 70°C
Dimension	Symbol			Unit	Conditions
Width	B max		29	mm	
Height	H max		13	mm	
Length	L max		45	mm	
Terminals					
Axial tinned wire	d		∅ 1.0 x 40	mm	
	M1				
	M0				
	Modification	Date	Visa émetteur		

Condensateurs CH 1400 Yverdon-les-Bains

Kondensatoren Tel.: ++41 24 445 66 88

Capacitors Fax: ++41 24 445 66 89

**Le lanché**  
**Capacitors**  
A FISCHER & TAUSSCH COMPANY

HJJ

28.08.2007

faisab5686.XLS