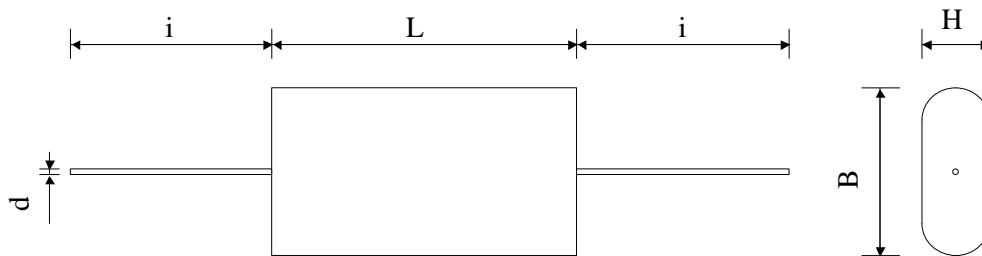

#5627

METALLIZED POLYPROYLLENE CAPACITORS

PPM 400-147 df K

Preliminary  
datasheet

Dielectric of metallized polypropylene

Plastic sleeve / Epoxy resin sealing

Parameter	Symbol		Value	Unit	Condition
Capacitance	C		0.047	$\mu\text{F}$	1 V / 1 kHz
Tolerance			$\pm 10$	%	
Rated voltage	Un DC		4000	VDC	
Rated voltage	Un AC		2000	Veff	
RMS current	I RMS max.			Aeff	10 kHz
slope of voltage variation	du/dt max.			V/ $\mu\text{sec}$	max. repetitive
Repetitive surge current	I cr. max			A	
Tangente delta	tg $\delta$		$\leq 5$	$10^{-4}$	1 V / 1 kHz
Tangente delta	tg $\delta$		$\leq 5$	$10^{-4}$	1 V / 10 kHz
Stray inductance	ESL		$\leq 50$	nH	
Insulation resistance	Ri		$> 100'000$	M $\Omega$	100 VDC - 1 min
Test voltage between terminals	U T1		6000	VDC	10 s
Climatic category			40/85/56		
Estimated operational life (-3%)			100'000	h	Un DC / 70°C
Dimension	Symbol			Unit	Conditions
Width	B max		30	mm	
Height	L max		70	mm	
Length	H max		20	mm	
Terminals					
Axial tinned wire	d		$\varnothing 1.0 \times 30$	mm	
	M1				
	M0				
	Modification	Date	Visa émetteur		

Condensateurs CH 1401 Yverdon-les-Bains  
 Kondensatoren Tel.: ++41 24 445 66 88  
 Capacitors Fax: ++41 24 445 66 89

**Le Janché**  
**Capacitors**  
A FISCHER & TALESCHE COMPANY

HJJ

16.01.2007

faisab5627.XLS