

#5785

METALLIZED POLYPROPYLENE CAPACITORS

PPM 40-4.7 df M

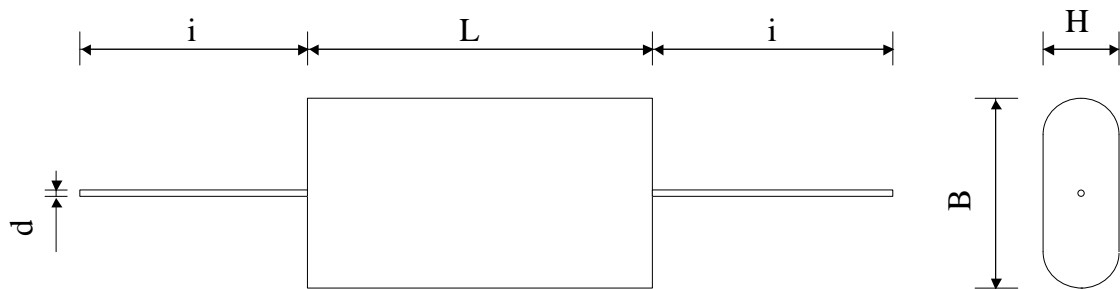

Dielectric of metallized polypropylene

Polyester wrapped

Epoxy resin sealing

Parameter	Symbol		Value	Unit	Condition
Capacitance	C		4.7	μF	1 V / 1 kHz
Tolerance			± 20	%	
Rated voltage	Un DC		400	VDC	
Rated voltage	Un AC		300	Veff	400 Hz
slope of voltage variation	du/dt max.		85	V/ μsec	max. repetitive
Repetitive surge current	I cr. max		400	A	
Tangent delta	tg δ		4	10^{-4}	1 V / 1 kHz
Tangent delta	tg δ		16	10^{-4}	1 V / 10 kHz
Stray inductance	ESL		≤ 40	nH	
Insulation resistance between terminals	Ri		$> 21'000$	M Ω	100 VDC - 1 min
Test voltage between terminals	U T1		1300	VDC	10 s
Operating temp.			- 40 / + 85 °C		
Estimated operational life (-5%)			$> 30'000$	h	400 VDC + 300 VAC 400 Hz / 85°C
Dimension	Symbol			Unit	Conditions
Width	B max		38	mm	
Height	H max		29	mm	
Length	L max		46	mm	
Terminals					
Axial tinned wire	d		$\emptyset 1.2 \times 35$	mm	
	M1				
	M0				
	Modification	Date	Visa émetteur		

Condensateurs CH 1400 Yverdon-les-Bains
 Kondensatoren Tel.: ++41 24 445 66 88
 Capacitors Fax: ++41 24 445 66 89

Le lanché
Capacitors
A FISCHER & TAUSSCHKE COMPANY

HJJ

03.02.2009

faisab5785.XLS