

#5559

METALLIZED POLYPROPYLENE CAPACITORS

PPM 100-8.0 cv2 K

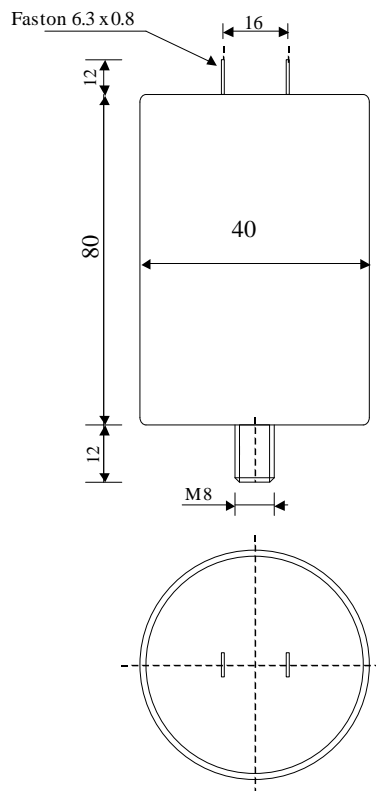

Dielectric of metallized polypropylene

FAST-ON 6.3 x 0.8 mm

Epoxy resin end sealing

Aluminium case

Parameter	Symbol	Value	Unit	Condition
Capacitance	C	8	$\mu\text{F}$	1 V / 1 kHz
Tolerance		$\pm 10$	%	
Rated voltage	Un DC	1000	VDC	
Rated voltage	Un AC	400	VAC	50 to 500 Hz
RMS Current	I <sub>eff max.</sub>	14	A <sub>eff</sub>	f > 10 kHz
slope of voltage variation	du/dt max.	70	V/ $\mu\text{sec}$	max. repetitive
Repetitive surge current	I cr. max	560	A	
Tangente delta	tg $\delta$	$\leq 7$	$10^{-4}$	1 V / 1 kHz
Equivalent serie resistance	ESR	12	m $\Omega$	1 V / 10 kHz
Stray inductance	ESL	$\leq 130$	nH	
Insulation resistance	Ri	> 2500	M $\Omega$	300 VDC - 1 min
Test voltage between terminals	U T1	1400	VDC	10 s
Climatic category		40/85/56		
Estimated operational life (-3%)		2000'000	h	Un DC / 70°C

Dimension	Symbol	Value	Unit	Conditions
Diameter	D	40	mm	
Heigth	H	80	mm	
Terminals				
fast-on		6.3 x 0.8	mm	
fixing stud		M8 x 12	mm	
	M1			
	M0			
	Modification	Date	Visa émetteur	

Condensateurs  
Kondensatoren  
Capacitors

CH 1401 Yverdon-les-Bains  
Tel.: ++41 24 445 66 88  
Fax: ++41 24 445 66 89

**Le lanché**  
Capacitors  
A FISCHER & TAUSSIG COMPANY

HJJ

20.04.2006

faisab5559.XLS