

#5795

Power Electronics Capacitors

MKT 10-6.8 SMD M

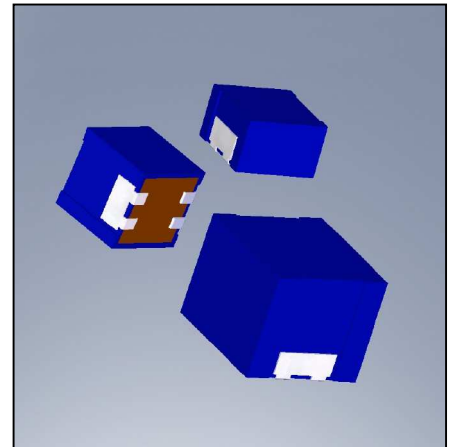
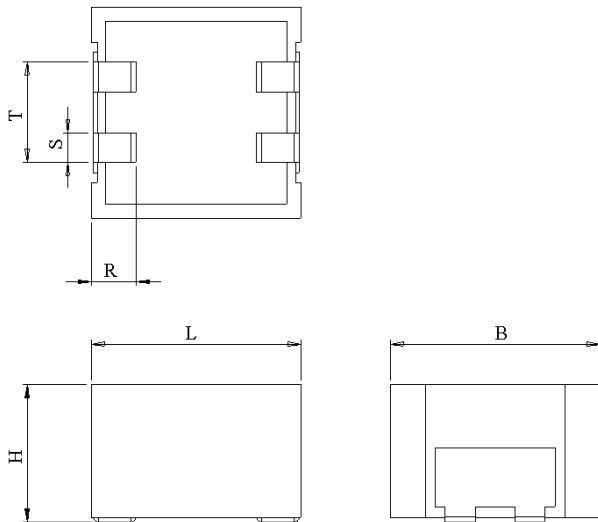

Surface mount device - Self-extinguishing plastic housing
Dielectric metallized polyester - Epoxy resin sealing UL 94-V0

Parameter	Symbol	Value	Unit	Condition
Capacitance	C	6.8	μF	1 V / 1 kHz
Tolerance		± 20	%	
Rated voltage	Un DC	100	VDC	
Rated voltage	Un AC	30	Veff	50 Hz
RMS current	I RMS max.	5.5	Aeff	300 kHz / 105 °C
Tangent delta	$\text{tg}\delta$	≤ 90	10^{-4}	1 kHz
Equivalent serie resistance	ESR	≤ 5.5	$\text{m}\Omega$	300 kHz
Stray inductance	ESL	≤ 5	nH	
Insulation resistance	Ri	> 184	$\text{M}\Omega$	100 VDC - 1 min
Test voltage between terminals	U T1	160	VDC	10 s
Climatic category		55/125/21		
Dimension	Symbol	Value	Unit	Conditions
Width	B max	15.5	mm	
Height	H max	12	mm	
Length	L max	16.5	mm	
Terminals				
	R	2.25 ± 0.25	mm	
	S	2 ± 0.2	mm	
	T	7.0 ± 0.2	mm	
	M1			
	M0			
	Modification	Date	Visa émetteur	

Condensateurs CH 1400 Yverdon-les-Bains
Kondensatoren Tel.: ++41 24 445 66 88
Capacitors Fax: ++41 24 445 66 89

Le Janché
Capacitors
A RIBSCHER & TAUSCHE COMPANY

HJJ

20.03.2009

faisab5795.XLS