

# 6011	METALLIZED POLYPROPYLENE + FILM-FOIL CAPACITORS	TYPE KPS 160-122 ds M
--------	--	--------------------------

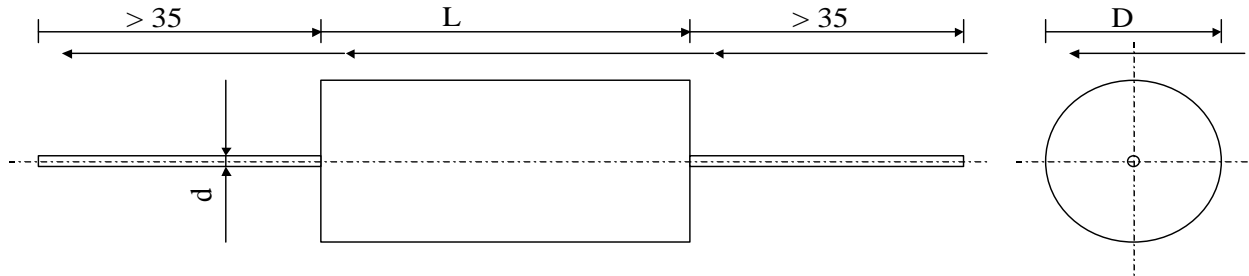

Dielectric: Polypropylene metallized + film + foil

Polyester wrapped UL 510 / Epoxy resin sealing UL 94-V0

Paramètre	Symbol	Value	Unit	Condition
Capacitance	C	22	nF	20°C, 1 kHz
Tolérance		± 20	%	
Rated voltage	Un DC	1'600	VDC	
Rated voltage	Un AC	500	VAC	
rated temperature		70	°C	
RMS Current	I _{eff} max.	4	A _{eff}	100 kHz
Slope of voltage variation	du/dt max.	4'000	V/μs	max. repetitive
Repetitive surge current	I _{cr} max	88	A	max. repetitive
Tangent delta	tgδ	< 4 E-4		1 v / 1 kHz
Tangent delta	tgδ	< 4 E-4		1 v / 10 kHz
Stray inductance	ESL	≤ 18	nH	
Insulation resistance between terminals	R _i	> 100'000	MΩ	500 VDC - 1 min
Test voltage between terminals	U _{T1}	2'560	VDC	10 s.
Climatic category		40/85/56		

Dimension	Symbole	Value	Unité	Conditions
Diameter	D	13.2	mm	
Length	L	33	mm	
Terminals				
Axial tinned wire	d	ø 1.0 x 35	mm	
	M2			
	M1			
	MC			
	Modification	Date	Visa émetteur	