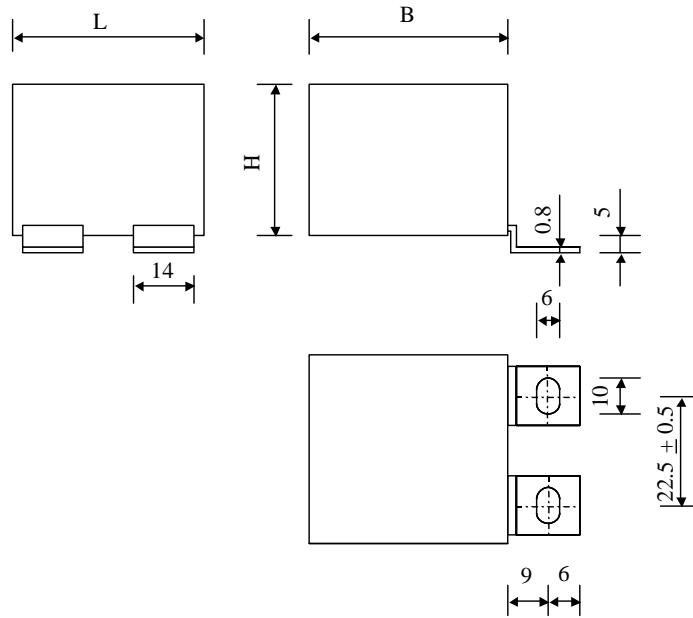

5723

**METALLIZED POLYPROPYLENE
+ FILM-FOIL CAPACITORS**
TYPE
KPS 160-015 cs2a K

Dielectric: Polypropylene metallized + film-foil

Self-extinguishing plastic housing / Epoxy resin sealing

Paramètre	Symbol	Value	Unit	Condition
Capacitance	C	150	nF	20°C, 1 kHz
Tolérance		10	%	
Rated voltage	Un DC	1'600	VDC	
Rated voltage	Un AC	550	VAC	
RMS Current 25 kHz	I _{eff} max.	19	A _{eff}	60°C max.
Slope of voltage variation	du/dt max.	3'867	V/μs	max. repetitive
Repetitive surge current	I cr. max	580	A	max. repetitive
Tangent delta	tgδ	≤ 4.0 E-4		1 V / 10 kHz / 20 °C
Equivalent serie resistance	ESR	≤ 16	mΩ	1 V / 25 kHz / 20 °C
Stray inductance	ESL	≤ 20	nH	
Insulation resistance	Ri	> 100'000	MΩ	100 VDC - 1 min
Test voltage between terminals	U T1	2'600	VDC	10 s.
Climatic category		55/100/56		
Estimated operational life (-3 %)		100'000	h	Un / 70°C

Dimension	Symbole	Value	Unité	Conditions
Width	B max	45	mm	
Height	H max	30	mm	
Length	L max	42.5	mm	
Terminals				
Tinned copper	RM	22.5	mm	
Tentatives Values only, subject to technical modification	M2			
	M1			
	M0			
	Modification	Date	Visa émetteur	

 Condensateurs CH 1401 Yverdon-les-Bains
 Kondensatoren Tel.: ++41 24 445 66 88
 Capacitors Fax: ++41 24 445 66 89

Le Janché
Capacitors
A FISCHER & TAUSSCH COMPANY

HJJ

22.05.2008

faisab5723.XLS