

Leclanché Capacitors  
48, av. de Grandson  
1400 Yverdon, Switzerland



Tel. +41 24 445 66 88  
Fax +41 24 445 66 89  
[capinfo@Lcap.ch](mailto:capinfo@Lcap.ch)  
[www.Lcap.ch](http://www.Lcap.ch)

Drawing No. : 1027425-53567  
created from : 07/07/2014 11:34:00

**Part Number : GMXA68216050105**

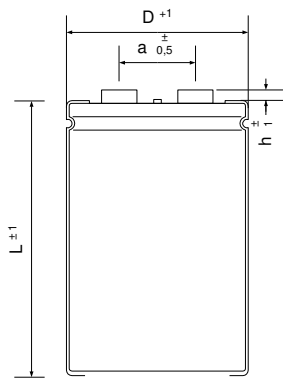

$\varnothing D$  : 50 mm  
 L : 105 mm  
 a : 22 mm  
 h : 4 mm  
 :  
 Terminals : M5

**Electrical Parameter**

|  |                              |                    |
|--|------------------------------|--------------------|
| Rated Capacitance ( $C_R$ )<br>@ 100 Hz / 20 °C      | <b>6800</b> $\mu$ F          |                    |
| Tolerance  | <b><math>\pm 20</math></b> % |                    |
| Rated Voltage ( $U_R$ )                              | <b>160</b> V                 |                    |
| Surge Voltage ( $U_S$ )<br>max. 5 x 1 min / h        | <b>184</b> V                 |                    |
| Reverse Voltage ( $U_U$ )<br>max. 1 s                | <b>2</b> V                   |                    |
| Leakage Current ( $I_L$ )<br>@ $U_R$ / 5 min / 20 °C | <b>6582</b> $\mu$ A          |                    |
| ESR typ.<br>@ 100 Hz / 20°C                          | <b>16</b> m $\Omega$         |                    |
| Tan $\delta$ typ.<br>@ 100 Hz / 20°C                 | <b>7</b> %                   |                    |
| Z max.<br>@ 10 kHz / 20°C                            | <b>13</b> m $\Omega$         |                    |
| ESL typ.   | <b>20</b> nH                 |                    |
| Rated Ripple Current ( $I_R$ )<br>@ 100 Hz / 85 °C   | <b>7</b> A                   |                    |
| Useful life<br>@ $I_R, U_R, 85$ °C                   | <b>12000</b> h               |                    |
| IEC Climatic category / Standards                    | <b>40/085/56</b>             | <b>IEC 60384-4</b> |
| Applications   | General Industrial           |                    |
| Your article No. / Project                           |                              |                    |