

Leclanché Capacitors
48, av. de Grandson
1400 Yverdon, Switzerland

Leclanché
Capacitors

A FISCHER & TAUSCHE COMPANY

Tel. +41 24 445 66 88
Fax +41 24 445 66 89
capinfo@LCap.ch
www.Lcap.ch

Drawing No. : 1026735-53567

created: hs 17/02/2014 14:35:00

Typ : GMA47406390235

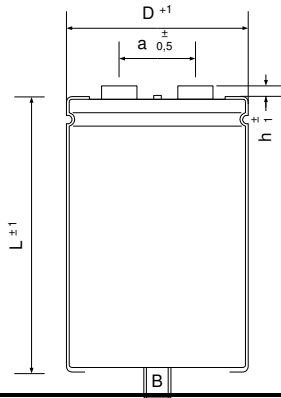

$\varnothing D$: 90 mm
L : 235 mm
a : 31,7 mm
h : 5 mm
B : M12
Terminals : M6

Electrical Parameters

Rated Capacitance (C_R) @ 100 Hz / 20 °C	470000 μ F	
Tolerance	± 20 %	
Rated Voltage (U_R)	63 V	
Surge Voltage (U_S) max. 5 x 1 min / h	72 V	
Reverse Voltage (U_U) max. 1 s	2 V	
Leakage Current (I_L) @ U_R / 5 min / 20 °C	177 mA	
ESR typ. @ 100 Hz / 20°C	1 m Ω	
Tan δ typ. @ 100 Hz / 20°C	27 %	
Z max. @ 10 kHz / 20°C	0,8 m Ω	
ESL typ.	20 nH	
Rated Ripple Current (I_R) @ 100 Hz / 85 °C	65 A	
Useful life @ I_R , U_R , 85 °C	8000 h	
IEC Climatic category / Standards	40/085/56	IEC 60384-4
Applications		
Your article No.. / Project		