

Leclanché Capacitors
48, av. de Grandson
1400 Yverdon, Switzerland



Tel. +41 24 445 66 88
Fax +41 24 445 66 89
capinfo@Lcap.ch
www.Lcap.ch

Drawing No. : 1011745-53567
created from : 10/06/2014 21:36:00

Part Number : EFVA 63-2200 35047

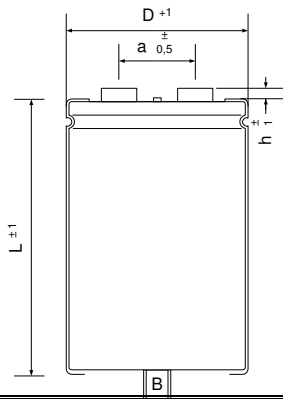

∅ D : 35 mm
L : 47 mm
a : 13 mm
h : 6 mm
B : M8
Terminals : M5

Electrical Parameter

Rated Capacitance (C _R) @ 100 Hz / 20 °C	2200 μF	
Tolerance	-10 +30 %	
Rated Voltage (U _R)	63 V	
Surge Voltage (U _S) max. 5 x 1 min / h	72 V	
Reverse Voltage (U _U) max. 1 s	2 V	
Leakage Current (I _L) @ U _R / 5 min / 20 °C	832 μA	
ESR typ. @ 100 Hz / 20°C	80 mΩ	
Tan δ typ. @ 100 Hz / 20°C	11 %	
Z max. @ 10 kHz / 20°C	64 mΩ	
ESL typ.	20 nH	
Rated Ripple Current (I _R) @ 100 Hz / 105 °C	2,67 A	
Useful life @ I _R , U _R , 105 °C	8000 h	
IEC Climatic category / Standards	40/105/56	IEC 60384-4
Applications	General Industrial	
Your article No. / Project		