

RoHS Compliant

REV	ECO NO.	DATE	BY	APP'D
A	REL TO PRODUCTION PER ECO 001	12/8/10	KL	

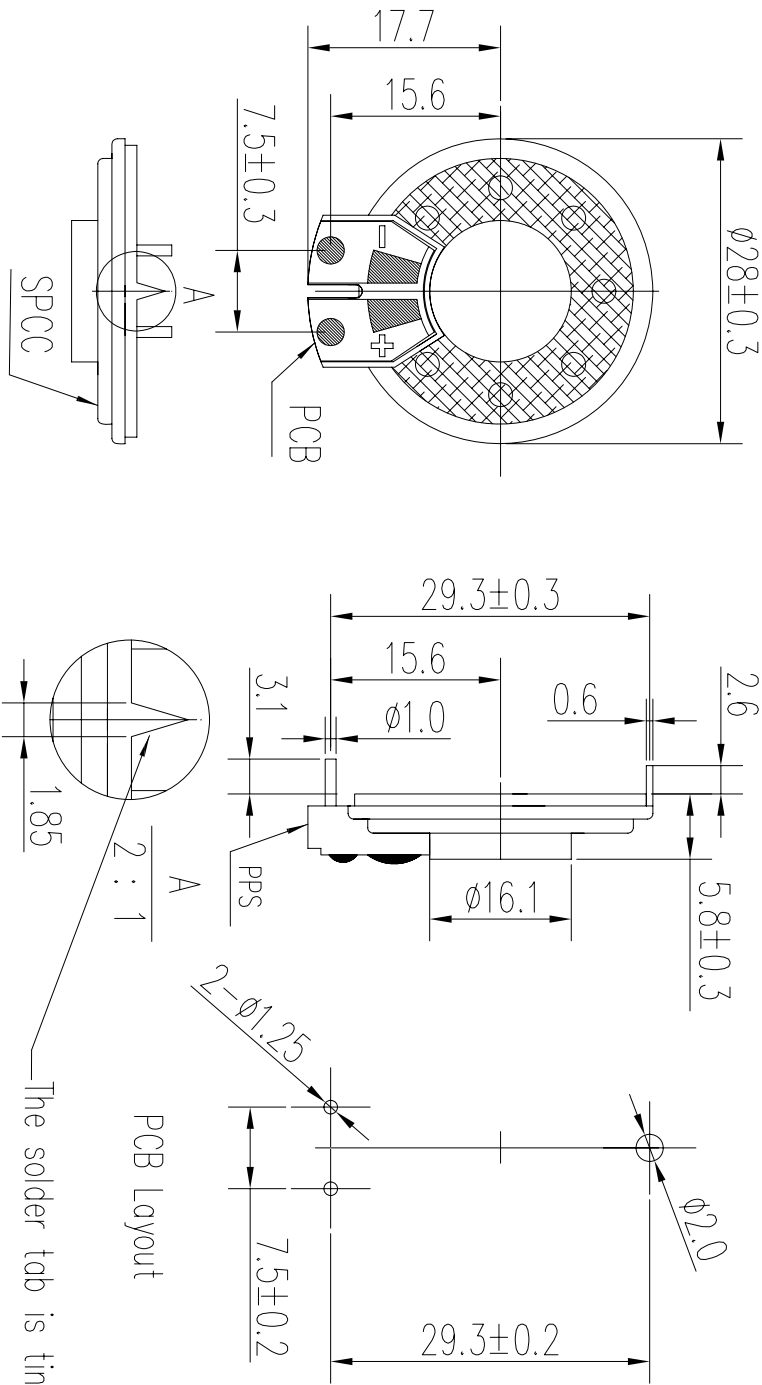

The solder tab is tin plated over nickel

Tolerance:
X.X ±0.5
X.XX ±0.3

UNIT: mm

Rated Impedance	8 Ohms ±15%
Rated Power	1.0W
Max. Power Input	1.5W
Resonant Frequency	500±20%Hz
Effective Freq. Range	280–18K Hz
SPL (dB)	82±3
Magnet Type	NdFeB
Cone Material	Standard Mylar
Mount Feet(1): Metal, Tin plated over nickel	
Pins(2): Tinned Copper	
Operating Temperature (°C)	–10~+40

CONFIDENTIAL

© Copyright 2010 Regal Electronics, Inc.
This drawing is the property of Regal Electronics and contains confidential information, trade secret information and/or know-how which is the property of Regal Electronics. By accepting this drawing, the recipient agrees not to provide, or otherwise make available, the drawing or any information or know-how embodied therein, to any third party without prior written authorization.

DRAWN: KIM	DATE: 12/8/10	TITLE: PCB MOUNT SPEAKER
CHECKED:	DATE:	
ENGINEER:	DATE:	
APPROVED:	DATE:	
APPROVED:	DATE:	
APPROVED:	DATE:	
SCALE: NONE	SIZE: B	DRAWING NO. RC-2808LNL
		REV A

A

B

C

D

A

B

C

D