

D-Subminiature Filtered Connectors

RoHS Compliant

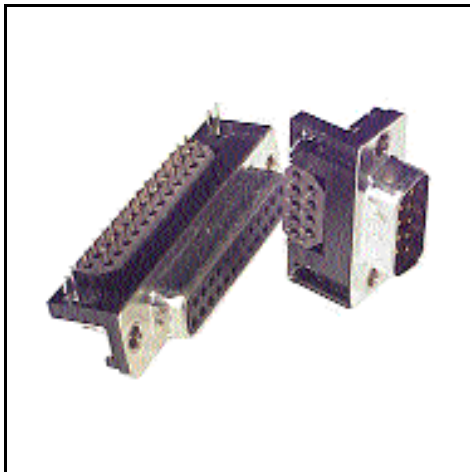

R4400-[*][**]

.318" Standard density

R4401-15[**]

.350" High density

*Number of contacts; Options are:

9, 15, 25

**Gender; Options are:

M = Male

F = Female

ELECTRICAL:

- Current rating: 5 AMP maximum
- Contact resistance: 15 milliohms maximum
- Insulation resistance: 1000 Megohms minimum
- Dielectric withstanding voltage: 1000 VAC

MATERIAL:

- Shell : Steel, tin plated
- Insulator: UL94V-0 / PBT glass filled
- Color: black
- Contact material: Pin = Brass,
Socket = Phosphor bronze
- Plating: 6μ" gold flash
- Temperature: -55°C to +105°C

FEATURES:

- High-performance ferrite material with superior frequency characteristics
- Noise attenuation in signal line of data communication terminals and digital devices
- Has minimal effect on transition waveforms
- Saves energy by integrating the filter element on the data line
- More cost effective than multiple bead core packaging
- Meets shielding requirements for FCC, VDE and VCCI specifications

R4400 Series

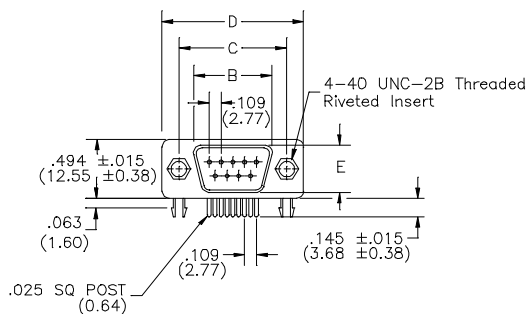

DIMENSION CHART		
MODEL	C ±	D ±
4400-09F	.984	1.216
4400-09M	(24.99)	(30.89)
4400-15F	1.312	1.539
4400-15M	(33.32)	(39.10)
4400-25F	1.852	2.090
4400-25M	(47.04)	(53.09)

	B ±	E ±
	.010(0.25)	.010(0.25)
MALE	.665	.329
	(16.90)	(8.29)
FEMALE	.642	.311
	(16.30)	(7.90)

IMPEDANCE CHARACTERISTICS
SINGLE TURN (INSIDE HOLE)

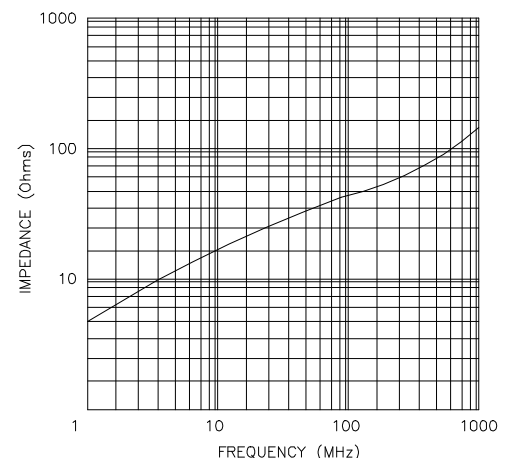

R4401 Series

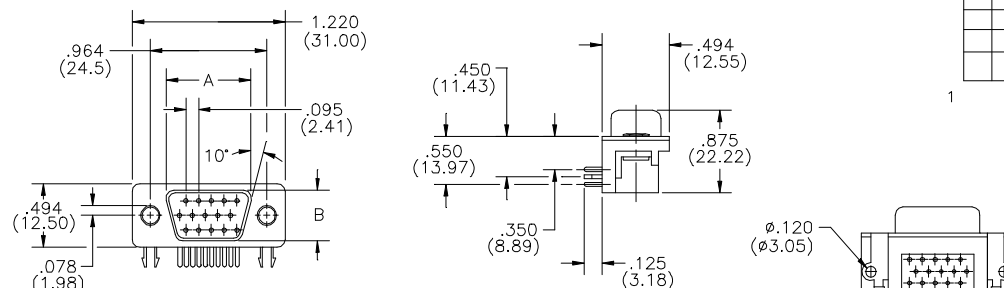

DIMENSION CHART		
MODEL	A ±	B ±
4401-15F	.642	.311
	(16.30)	(7.90)
4401-15M	.665	.327
	(16.90)	(8.30)

080520

120 San LuCar Court ▼ Sunnyvale, CA 94086 ▼ Phone 800/882-8086 ▼ Fax 800/345-2831

Visit www.regalusa.com ▼ E-mail hal@regalusa.com