

152[\*]-8-[\*]-[\*]-[\*]

Category-3

155[\*]-8-[\*]-[\*]-[\*]

Category-5e



\*Type of shield; Options are:

**S** = Shielded without tabs

**Blank** = Unshielded

\*\*Number of ports; Options are:

**1** = 1 Port      **6** = 6 Port

**2** = 2 Port      **8** = 8 Port

**4** = 4 Port

\*\*\***F** = Ferrite filter option

\*\*\*\* **NL** = RoHS Compliant

**A** = Alternate front ground tab option available only for single port connectors (Add A after type of shield e.g. 155SA-8-1 or 152SA-8-1)

## FEATURES:

- Designed for the latest ethernet and ATM applications
- Gigabit ethernet ready
- Ethernet crosstalk offers up to 10 dB better than CAT-5 specifications
- ATM Crosstalk offers up to 20 dB better than CAT-5 specifications
- Fits existing CAT-3 & CAT-5 designs with standard footprint
- 50μ" Gold/FCC 68 sub part F compliant

## ELECTRICAL:

- Insulation resistance: 500 MegOhms minimum
- Dielectric withstand voltage: 1000V RMS
- Contact resistance: 30 milliohms maximum
- Durability: 1000 mating cycles
- Operating temperature: -20°C to +85°C

## MATERIAL:

- Housing: UL94V-0 / PBT glass filled
- Shield: Tin plated copper alloy
- Contacts: Phosphor bronze 50μ" gold over nickel

## 1-Port (PCB ground tabs)

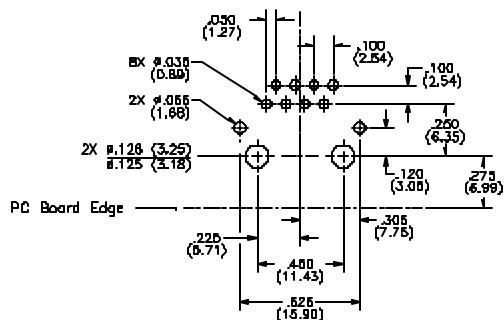
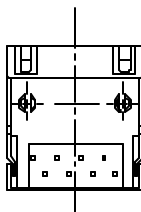
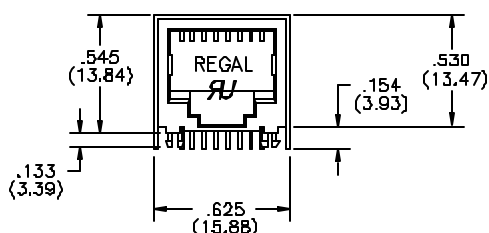

Alternate ground tab option available with 1 Port only

