

spectre WR

Wall mounted cylindrical LED luminaire for outdoor applications

LED IP65 60+

Optics

- Light output options:
 - 2620 lumens (4000K - 27W)
- Downward distribution
- Bi-symmetrical 130° x 70° beam (White LED version)
- Zero light pollution
- 4mm thick, thermal shock resistant, tempered clear flat glass

Body

- Die cast aluminium
- Coated for corrosion and saline environment resistance
- IP65 IK08 rated protection
- Requires wall mounting bracket (order separately)
- Finished in Graphite Grey with Silver trim
- Suitable for ambient temperatures between -20°C to +40°C



Order Codes

Spectre WR

2620 Lumen (27W) White

SPRAH14K

Accessories

Wall mounting bracket

SPRWMBRK

Dimensions

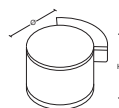

Ø	H	KG
256*	225	4.5

*Head only, with bracket = 300

LED Performance

Colour Temp	Ra (CRI)	Life Expectancy	Colour Consistency
4000K	≥ 80	L ₇₀ (60,000hrs)	MacAdam 4 SDCM

Photometric Performance

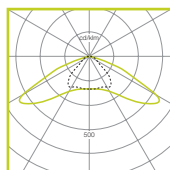

26W 2620 lumen
• LOR = 100%

To Specify

IP65 Wall mounted cylindrical LED luminaire with die cast aluminium body. With downward distribution having zero upward light – as Whitecroft Lighting SPECTRE WR.